

**ADDENDUM NO. 1**  
**AUGUST 27, 2025**

**PROJECT: CITY OF IDALOU**  
**MULTI-PURPOSE COURT IMPROVEMENTS**

**BID DATE: SEPTEMBER 3, 2025**

The following changes and/or additions shall be made to the Plans, Specifications, and Contract Documents for the above referenced project. Bidder shall acknowledge receipt of this Addendum by signing below and returning this Addendum with the Bid.

**1) PLAN SET**

Fence Detail has been updated see General Details on sheet 05. Fence Brace Detail has been deleted. Fence Enclosure detail no longer has #3 rebar to tie at the base of the chain link fence. The footings have also been updated to minimum of 40" deep.

**2) BID SCHEDULE**

The bid schedule has been updated with additional items to be deducted from the bid.

**3) SPECIFICATIONS**

**Revision of Section 32 13 65 – Surfacing for Concrete Basketball and Pickleball Court**  
**Part 1 General; 1.9 Qualifications**

The basketball and pickleball court surfacing installer shall submit a list of completed basketball and pickleball court projects, including client's name, project location, date of completion, and the Owner's contact telephone number. The installer shall have at least 5 years experience in surfacing of multi-purpose outdoor play surfaces similar to this project.

**4) CONTRACTOR QUESTIONS**

- a) **Q1. Can the holes for each fence post be a straight walled 18" hole?**  
A1. Yes.
- b) **Q2. Do the post holes and slab have to be poured monolithically?**  
A2. Yes.
- c) **Q3. Do the post holes require rebar?**  
A3. No.
- d) **Q4. 1. Is the fence stem poured integrally with the court or is it a separate structure separated by an expansion joint?**  
A4. See answer A2.
- e) **Q5. Can a bottom rail be utilized on the fence instead of the two No 3 Rebar ties and 9 ga galvanized wire?**  
A5. We have removed using the No. 3 rebar to tie at the base of the chain link fence. The detail for the 9 gauge galvanized wire will still be used. Due to the cost increase we don't want to use a rail for the bottom of the fence.
- f) **Q6. Where and at what frequency are fence braces required?**  
A6. This detail has been removed. No bracing will be needed on this project.

---

**Bidder's Acknowledgment**

---

**Date**

**Prepared by:**

**JACOB | MARTIN**  
**TBPE Firm No. 2448**

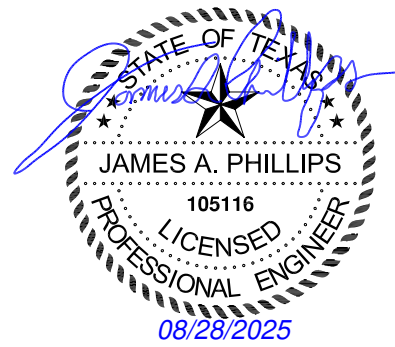

# CITY OF IDALOU

## MULTI-PURPOSE COURT IMPROVEMENTS

### BASE BID SCHEDULE A

Show prices in numerals. Round off unit prices to two decimal places only.

These Bid Prices must include all labor, materials, equipment, insurance, overhead, superintendence, transportation, taxes, permits, profits & incidentals to cover the finished Work called for in the Contract Documents.

**For all Labor, Materials, Equipment and Incidentals to Furnish and Install the Following:**

<b>Bid Item</b>	<b>Description</b>	<b>Est. Qty.</b>	<b>Unit</b>	<b>Unit Price</b>	<b>Extended Amount</b>
1	Mobilization, Bonds, and Insurance	1	LS	\$	\$
2	Erosion Control	1	LS	\$	\$
3	Remove Existing Fencing	315	LF	\$	\$
4	Remove Existing Concrete Slab	7,223	SF	\$	\$
5	Remove Existing Concrete Sidewalk	597	SF	\$	\$
6	Remove Existing Curb and Gutter	75	LF	\$	\$
7	Remove Existing Asphalt	200	SF	\$	\$
8	Standard Concrete Slab on Grade (Multi Purpose Court)	5,920	SF	\$	\$
9	Portable Pickleball Net	1	EA	\$	\$
10	Basketball Goals	2	EA	\$	\$
11	Court Surfacing and Markings	4,700	SF	\$	\$
12	10' Perimeter Fencing w/ Pedestrian Gate	315	LF	\$	\$
13	Asphalt Repair	200	SF	\$	\$
14	Concrete Sidewalk	270	SF	\$	\$
15	Curb and Gutter	75	LF	\$	\$
16	ADA Ramp	90	SF	\$	\$
17	Parking Stall Striping, ADA Striping, ADA Signage and Wheel Stop	1	LS	\$	\$
<b>TOTAL BASE BID A (Items 1 - 17)</b>					<b>\$</b>

<b>PROPOSED NUMBER OF DAYS FOR COMPLETION*</b>	<b>DAYS</b>
--	-------------

**\*Contractor must enter proposed number of days on Bid Proposal pages BP-1 & BP-4.**

**CITY OF IDALOU**  
**MULTI-PURPOSE COURT IMPROVEMENTS**  
**ADDITIVE (A) or DEDUCTIBLE (D) ALTERNATE BID SCHEDULE**

Show prices in numerals. Round off unit prices to two decimal places only.

These Bid Prices must include all labor, materials, equipment, insurance, overhead, superintendence, transportation, taxes, permits, profits & incidentals to cover the finished Work called for in the Contract Documents.

**For all Labor, Materials, Equipment and Incidentals to Furnish and Install the Following:**

<b>Bid Item</b>	<b>Description</b>	<b>Est. Qty.</b>	<b>Unit</b>	<b>Unit Price</b>	<b>Extended Amount</b>
<b>D1</b>	Remove Existing Concrete Slab	7,223	SF	\$	\$
<b>D2</b>	Remove Existing Fencing	315	LF	\$	\$
<b>D3</b>	Remove Existing Concrete Sidewalk	597	SF	\$	\$
<b>D4</b>	Remove Existing Curb and Gutter	75	LF	\$	\$
<b>D5</b>	Remove Existing Asphalt	200	SF	\$	\$
<b>D6</b>	4' Concrete Buffer	1,220	SF	\$	\$
<b>D7</b>	Court Surfacing and Markings	4,700	SF	\$	\$
<b>D8</b>	ADA Ramp	90	SF	\$	\$
<b>D9</b>	Parking Stall Striping, ADA Striping, ADA signage and Wheel Stop	1	LS	\$	\$
<b>D10</b>	Curb and Gutter	75	LF	\$	\$
<b>D11</b>	Concrete Sidewalk	270	SF	\$	\$
<b>D12</b>	Asphalt Repair	200	SF	\$	\$
<b>TOTAL DEDUCTIBLE ALTERNATE BID (Items D1-D12)</b>					<b>\$</b>

**ADDITIVE ALTERNATE BID**

<b>A1</b>	Court Lighting with Panel	4	EA	\$	\$
<b>A2</b>	9' Tall Wind Screens for New Fence	315	LF	\$	\$
<b>TOTAL ADDITIVE ALTERNATE BID (Items A1-A2)</b>					<b>\$</b>

**Note: Owner reserves the right to accept any combination of base bid and additive/deductible alternate bid items.**

**SECTION 32 13 65 - SURFACING FOR CONCRETE BASKETBALL AND PICKELBALL COURT**

**PART 1 GENERAL**

**1.1 SECTION INCLUDES**

- A. Surfacing proposed concrete basketball and pickleball court.

**1.2 RELATED REQUIREMENTS**

**1.3 SUBMITTALS**

- A. See Section 01 30 00 - Administrative Requirements for submittal procedures.
- B. Product Data: For each type of product..
  - 1. Provide detailed preparation guidelines and step-by-step application instructions
- C. Provide Samples for each type of topcoat product
- D. Samples for Initial Selection:for each type of product.
  - 1. Submit Samples on rigid backing, 8 inches square
  - 2. Apply coats on samples in steps to show each coat required for system.

**1.4 DELIVERY, STORAGE, AND HANDLING**

- A. Store unused materials in tightly sealed containers located in well-ventilated areas, where the ambient temperature is consistently maintained at a minimum of 45 Degrees F.
  - 1. Keep all containers clean and free of contaminants or residue.
  - 2. Remove rags and waste materials from storage areas on a daily basis.

**1.5 FIELD CONDITIONS**

- A. Apply coatings only when both the surface and ambient air temperatures are between 50°F and 95°F, or within the temperature range specified by the manufacturer.
- B. Do not apply paint under the following conditions: when relative humidity exceeds 85 percent, when the temperature is less than 5°F above the dew point, on damp or wet surfaces, or contrary to manufacturer recommendations.

**1.6 WARRANTY**

- A. The Installer and Manufacturer shall warrant the Work for a period of two (2) years from the date of Substantial Completion as confirmed by the Owner. This warranty shall cover the following, ensuring that the court preparation materials and surfacing treatments:
  - 1. Have been manufactured and applied in accordance with these Specifications and the Manufacturer's requirements.
  - 2. Properly adhere, bond, and remain fastened to the newly constructed courts and preparation materials.
  - 3. Have been applied in the specified quantities and thicknesses.
  - 4. Will perform in accordance with the Manufacturer's currently published product literature and Specification sheets.

**1.7 PROTECTION OF EXISTING IMPROVEMENTS**

- A. The Contractor is responsible for protecting all existing improvements—such as buildings, lawn areas, landscaping, curbing, parking lots, fences, net posts, wind screens, and similar features—from damage, discoloration, or unintended application of surfacing materials. These areas must be properly masked or otherwise protected. Any damage or adverse effects caused by the Contractor's operations shall be cleaned, repaired, or restored to their original condition at the Contractor's expense.

**1.8 STANDARDS AND WORKMANSHIP**

- A. Pickleball court color finishes and preparation materials shall be applied using methods generally consistent with the standards set by the U.S. Pickleball Association (USPA) and the

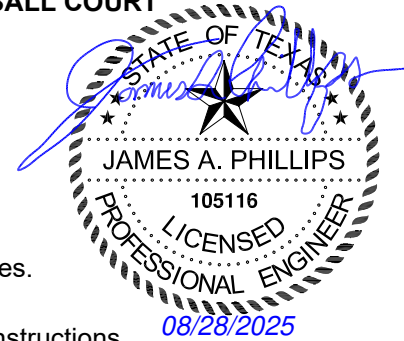

USA Basketball. In the event of any conflict between those standards and this Specification, the requirements of this Specification shall take precedence. Any work that does not meet the specified requirements shall be removed or corrected by the Contractor at their own expense, with no extension of time granted for completion. All corrective actions shall be performed as directed by the Engineer or Owner.

## **1.9 QUALIFICATIONS**

- A. The basketball and pickleball court surfacing installer shall submit a list of completed basketball and pickleball court projects, including client's name, project location, date of completion, and the Owner's contact telephone number. The installer shall have at least 5 years experience in surfacing of multi-purpose outdoor play surfaces similar to this project.

## **PART 2 PRODUCTS**

### **2.1 COURT PREPARATION MATERIALS**

- A. Acid Cleaning and Etching - Concrete Court Surface  
An acid pre-treatment shall be applied to uncoated Portland cement concrete surfaces to clean, etch, and prepare the surface for subsequent material applications.
  - 1. Use "Concrete Preparer", manufactured by California Products Corporation (containing phosphoric acid and zinc chloride), or an approved equal. This product is self-neutralizing, requires no rinse, and creates a water-insoluble surface reaction. This reaction forms a barrier that minimizes the osmotic effects of moisture and water vapor, helping to prevent blisters and ensuring proper adhesion of subsequent coatings.
  - 2. Acid treatment shall be applied only to previously uncoated or untreated Portland cement concrete surfaces.
- B. Primer – Concrete Court Surface  
After acid pre-treatment, a lightly pigmented acrylic emulsion primer shall be applied to the concrete surface to promote bonding of subsequent materials.
  - 1. Use "California Ti-Coat", manufactured by California Products Corporation, or an approved equal.
  - 2. Priming shall be performed only on previously uncoated Portland cement concrete surfaces.
- C. Crack Filler  
Crack filler shall be an acrylic latex, high-solids compound that is pourable, injectable, or pressure-applied. Once cured, it must remain highly flexible, exhibit minimal expansion/contraction under temperature changes, and be waterproof. It must adhere to the interior surfaces of cracks and serve as a compatible base for subsequent patching materials, slurry coats, and color finishes.
  - 1. Use "Plexipave Crack Filler", manufactured by California Products Corporation, or an approved equal.
- D. Deep Patching Material  
For depressions or areas deeper than 1/4 inch, a high-strength patching material shall be used. It shall consist of an acrylic latex bonding liquid mixed with silica sand and Portland cement. Deep patching shall only be performed as directed by the Owner's Representative.
  - 1. Use "Court Patch Binder", manufactured by California Products Corporation, or an approved equal.
- E. Slurry – Base Filler Coat and Shallow Patching
  - 1. Slurry material shall be an acrylic latex binder designed for mixing with water, graded silica sand, and Portland cement. It shall form a smooth, uniform slurry with thickness not exceeding 1/4 inch per coat. Slurry shall be applied for the following purposes:
    - a. Patch shallow depressions (birdbaths) in multiple thin layers ( $\leq$  1/4 inch each).

- b. Fill hairline cracks, pores, and other minor surface irregularities.
- c. Level the surface in preparation for color coating.
- d. Provide a consistent texture across the court for uniform appearance, traction, ball bounce, and playability.
2. Use black-pigmented "California Acrylic Resurfacer", manufactured by California Products Corporation, or an approved equal.
3. Apply a minimum of two (2) slurry coats over the entire court surface (refer to PART 3 – EXECUTION).
4. Note: The use of asphaltic emulsion in base filler coats is strictly prohibited.

## **2.2 COLOR FINISH MATERIALS**

- A. Color finish materials shall consist of highly pigmented, texturized acrylic latex coatings formulated exclusively with inert mineral pigment colorants suitable for exterior use. The coating shall contain sufficient filler to ensure uniform texture and appearance and must be fade-resistant, tack-free, and resistant to deterioration from temperature changes, moisture, and ultraviolet radiation. Coatings must not include any ingredients that could damage the existing or newly applied court surfaces or preparation materials. The color finish system shall contain no vinyls, butadiene styrene, alkyds, asphalt, tar emulsions, or non-acrylic resins. Thinning shall be done only with clean water and strictly in accordance with the manufacturer's instructions.
- B. Apply a minimum of two (2) coats of job-mixed "Fortified Plexipave" and one (1) final coat of "Plexichrome", manufactured by California Products Corporation, or an approved equal.
- C. Final color selection (two colors) shall be made by the Owner. A current manufacturer's color chart shall be included in each submittal package, as required under PART 1 – GENERAL.

## **2.3 STRIPING PAINT**

- A. Striping paint shall be a non-glare, high-hiding, highly reflective acrylic latex paint. Oil-based or solvent-type paints are not permitted. The paint shall be pre-mixed with fine silica fillers, per the manufacturer's recommendations, to provide a textured line finish matching the court surface texture.
- B. Paint shall be a 100% acrylic emulsion containing no alkyds, vinyls, or butadiene styrene. Thinning shall be with water only. The paint must be suitable for application by brush, spray, or roller. All ingredients must be of commercial-grade quality, appropriate for long-term exterior use.
  1. For white striping paint, the pigment shall include rutile titanium dioxide as the primary opaque component.
  2. The vehicle shall consist of 100% acrylic polymer dispersed in water, with only essential additives such as pigment dispersants, anti-foaming agents, and preservatives.
  3. Driers are not allowed.
  4. White paint shall meet the following minimum requirements:
    - a. Total solids: 51.5% (by weight)
    - b. Maximum pigment content: 34% (by weight)
    - c. Titanium dioxide content: Minimum 3 lbs/gallon
    - d. Fineness of grind: Minimum 4
    - e. Viscosity: 70–85 Krebs Units
  5. Paint shall exhibit excellent brushing, leveling, and spreading characteristics.
- C. Use "Hi-Hide Plexicolor Line Paint" (white), manufactured by California Products Corporation, or an approved equal.

## **2.4 MATERIAL LABELS AND CONTAINERS**

- A. All surfacing and patching materials shall be delivered to the site in original, sealed containers bearing the manufacturer's label and batch code number. Materials packaged or labeled

inconsistently with these requirements will not be accepted. All water required for mixing shall be clean, fresh, and added on-site only.

## **2.5 APPROVED EQUAL SUBSTITUTIONS**

- A. The following products may be considered as acceptable substitutes, subject to written approval by the Owner and Engineer:
1. Court Master
  2. Laykold
  3. Novacrylic
  4. Dynaflex
  5. WorldClass

## **PART 3 EXECUTION**

### **3.1 SURFACE PLANE AND CONDITION OF PICKLEBALL COURTS**

- A. The basketball/pickleball court pavement must be installed to meet specified slope, pitch, and grade requirements. No surface variation shall exceed 1/8 inch when measured with a 10-foot straightedge in any direction.
1. Minor surface irregularities must be corrected as outlined in Section 3.9.
  2. Significant defects or poor pavement quality shall be reported to the Owner's Representative for further instruction.
  3. Concrete surfaces must have a uniform light broom finish. Alternate finishes are not acceptable and must be corrected using approved methods prior to the commencement of any surface work.

### **3.2 ADVERSE CONDITIONS**

- A. No court preparation or color surfacing materials shall be applied under adverse environmental conditions, which include (but are not limited to):
1. Airborne pollutants
  2. Blowing sand or debris
  3. High humidity
  4. Any form of precipitation (current or forecasted)
  5. Extreme temperatures
  6. Unsuitable surface conditions
  7. Other factors as defined by the product manufacturers that could impair product performance or final results
- Work shall not be performed when:
1. Ambient temperatures are below 50°F or expected to drop below 50°F during curing/drying
  2. Surface temperature exceeds 140°F
- B. Material Protection
- All materials and containers stored on-site must be protected from extreme heat, cold, and direct sunlight to prevent damage or degradation of product performance.

### **3.3 ORDER OF WORK**

- A. The following steps must be completed in the order listed. Allow proper drying and curing time between each step as per manufacturer guidelines.
- B. Initial Curing: Allow the concrete court pavement to cure for a minimum of 30 days before starting surface treatments.
- C. Grind off ridges and bumps if necessary. Feather all edges to avoid texture differences. Tools may include a terrazzo grinder, hand stone, or scraper.
- D. Sweep and wash all court surfaces.
- E. Perform acid treatment on entire surface (after test area is approved).



- F. Apply epoxy primer.
- G. Apply one coat of acrylic resurfacer.
- H. Fill cracks as needed.
- I. Patch birdbaths and deep areas if directed.
- J. Apply two coats (minimum) of acrylic resurfacer.
- K. Apply two coats of job-mixed Fortified Plexipave.
- L. Apply one coat of Plexichrome (no sand).
- M. Paint court striping.
- N. Final cleanup.
- O. Inspection and approval by Owner's Representative.

### **3.4 SWEEPING AND WASHING COURTS**

- A. All court surfaces must be thoroughly cleaned before beginning any subsequent work.
- B. Sweeping: Remove gravel, dust, loose soil, plant debris, chipped concrete, and all foreign materials.
- C. Washing: Clean surfaces using scrub brushes, strong detergent, and a high-pressure water stream to remove grease, oil, dirt, and pollutants.

### **3.5 ACID TREATMENT**

- A. Conduct a test application on a small corner section of the court. Proceed with full application only upon approval from the Owner's Representative.
- B. Application Procedure:
  - 1. Mix 1 gallon of "Concrete Preparer" with 4 gallons of clean water.
  - 2. Apply at a rate equivalent to 1 undiluted gallon per 700–900 square feet.
  - 3. Pour and spread liberally with a broom.
  - 4. Do not rinse. Allow surface to dry completely.
  - 5. Use a broom or squeegee to disperse puddles after reaction ends.

### **3.6 PRIMING**

- A. Apply a thin, even coat of epoxy primer to cleaned, acid-treated concrete using a short nap phenolic core roller.
  - 1. Apply one coat of acrylic resurfacer within 1 to 2 hours after priming.

### **3.7 CRACK FILLING**

- A. All cracks must be thoroughly cleaned using compressed air or high-pressure water.
  - 1. Structural cracks or signs of slab settlement must be reported to the Owner's Representative.
  - 2. For minor or hairline cracks:
    - a. Apply crack filler with a blunt-nose hand trowel or broad knife to a minimum depth of 1/4 inch.
    - b. Wipe surrounding edges clean with a damp cloth to prevent buildup and avoid the need for sanding.

### **3.8 DEEP PATCHING**

- A. Deep patching shall be performed only as directed by the Owner's Representative to repair major pavement defects.
- B. For depressions up to 3/4 inch thick, use the following patch mix applied by steel trowel or metal screed to fill and level the area:
  - 1. 100 lbs #100 mesh silica sand
  - 2. 3 gallons "Court Patch Binder"
  - 3. 1 gallon Portland cement

- C. Mix thoroughly in a clean mortar box or mixer to a workable consistency. Add a small amount of water if surface temperatures are high to improve workability. Apply patch directly to cleaned depressed areas. Allow patch to cure for 24 hours before applying subsequent materials.
- D. For depressions deeper than 3/4 inch, apply multiple patching layers with 24 hours curing time between coats. Feather each layer to a fine edge. Smooth rough edges by grinding or abrasive rubbing.

### 3.9 PATCH BIRDBATHS AND MINOR SURFACE IRREGULARITIES

- A. Identification: A birdbath is a depression where water collects after rain or flooding. All courts will be flooded under Owner's supervision. After drying, any depression holding water deeper than a new 5-cent coin shall be marked (chalk or keel) for patching.
- B. Mixing: Prepare shallow patch slurry as follows:

Material	Quantity
Acrylic Resurfacer	55 gallons
Water	28 gallons
Sand (40-60 mesh)	1,100 lbs
Portland Cement (Type I or Hi Early)	4 lbs

- C. Filling: Apply the patch slurry to birdbaths once courts are flooded and dry. If needed, apply multiple coats not exceeding 1/4 inch each to build up the patch. Avoid overly thick layers to ensure proper curing and adhesion.
- D. Leveling: Use a trowel or straight edge longer than the birdbath width to level the patch flush with surrounding surfaces. Birdbaths are typically circular or elliptical; finished patches should be roughly square or rectangular and aligned parallel to court edges.
- E. Other Irregularities: Patch other surface imperfections similarly, adjusting patch thickness to the depth of irregularities. Bumps and ridges should be removed prior to sweeping and acid treatment.

### 3.10 APPLY SLURRY FOR BASE FILLER COATS

- A. Begin only after all prior steps are completed and approved by the Owner's Representative.
- B. Mixing: Prepare "Acrylic Resurfacer" slurry per manufacturer guidelines, adjusting water-sand ratios as needed to achieve a uniform texture and level surface (see PART 2 - PRODUCTS). Target a creamy, spreadable slurry that resists sand separation, using the following mix proportions:

Material	Quantity
Acrylic Resurfacer	55 gallons
Water	20–40 gallons
Sand (60-80 mesh for first coat, 720 sand for second)	600–900 lbs

Liquid yield approximately 112–138 gallons.

- C. Mix thoroughly with clean, dry sand and potable water. Adjust sand and water quantities by up to 10% based on surface roughness and temperature.
- D. Application:
  - 1. Apply slurry uniformly with a 24 to 36-inch, 70 Durometer flexible rubber squeegee.
  - 2. Achieve a smooth, consistent surface that completely covers all concrete imperfections without shrinkage or mud cracks.
  - 3. Allow each coat to dry fully before applying the next. Remove ridges and rough spots by scraping prior to subsequent coats.

4. Apply a minimum of two coats; add more if necessary to meet finish requirements.
5. Coverage rate: 1 gallon unmixed acrylic resurfacer per 135–180 sq ft per coat.
6. Maximum thickness per coat: 1/4 inch.

### **3.11 APPLY COLOR FINISH COATS**

- A. Begin only after base slurry coats are complete and approved.
- B. Job-Mixed Fortified Plexipave:
  1. Mix components as follows:
    - a. Plexipave Color Base: 30 gallons
    - b. Plexichrome: 20 gallons
    - c. Water: 20 gallons
  2. Adjust mixture on-site within approved limits based on surface porosity and ambient temperature.
- C. Application:
  1. Apply at least two coats using 24- or 36-inch, 50 Durometer long flexible rubber squeegees approved by the manufacturer.
  2. Coverage: 1 gallon of mix per 135–180 sq ft, depending on surface porosity.
  3. Apply final coat crosswise to the court's length.
  4. Ensure a smooth, uniform surface free of puddles, thick spots, or mud cracking.
  5. Inspect carefully before the final coat; remove ridges, debris, and bumps.
- D. Plexichrome Finish Coat:
  1. Dilute Plexichrome no more than 1:1 with water.
  2. Apply with a wide hair push broom or rubber squeegee followed by a broom.
  3. Application is crosswise to court length.
  4. Coverage rate: 1 undiluted gallon per 180–225 sq ft.
- E. Color Uniformity: The finished court shall display uniform color from 25 feet away, at midday, when viewed from any edge.

### **3.12 PAINT COURT STRIPING**

- A. Apply 2-inch-wide textured white lines per U.S. Pickleball Association specifications.
  1. Lines shall be accurately marked according to drawings.
  2. Apply paint using brush, roller, or spray, ensuring no fogging, splatter, or overspray.

### **3.13 CLEAN UP**

- A. The contractor shall remove and properly dispose of all containers, excess materials, rubbish, debris, and other waste generated by the work.
  1. The site shall be left clean, orderly, and acceptable to the Owner.

### **3.14 INSTALLATION**

### **END OF SECTION**

This page intentionally left blank

X:\0\_Idalou\25285 - 2025 - Multi Purpose Court Improvements - City of Idalou\Drafting\Plans\Civil\05 GENERAL DETAILS.dwg Saved By: bday Save Time: 8/8/2025 12:23 PM Plotted By: sarah davis Plot Date: 8/27/2025 12:09 PM

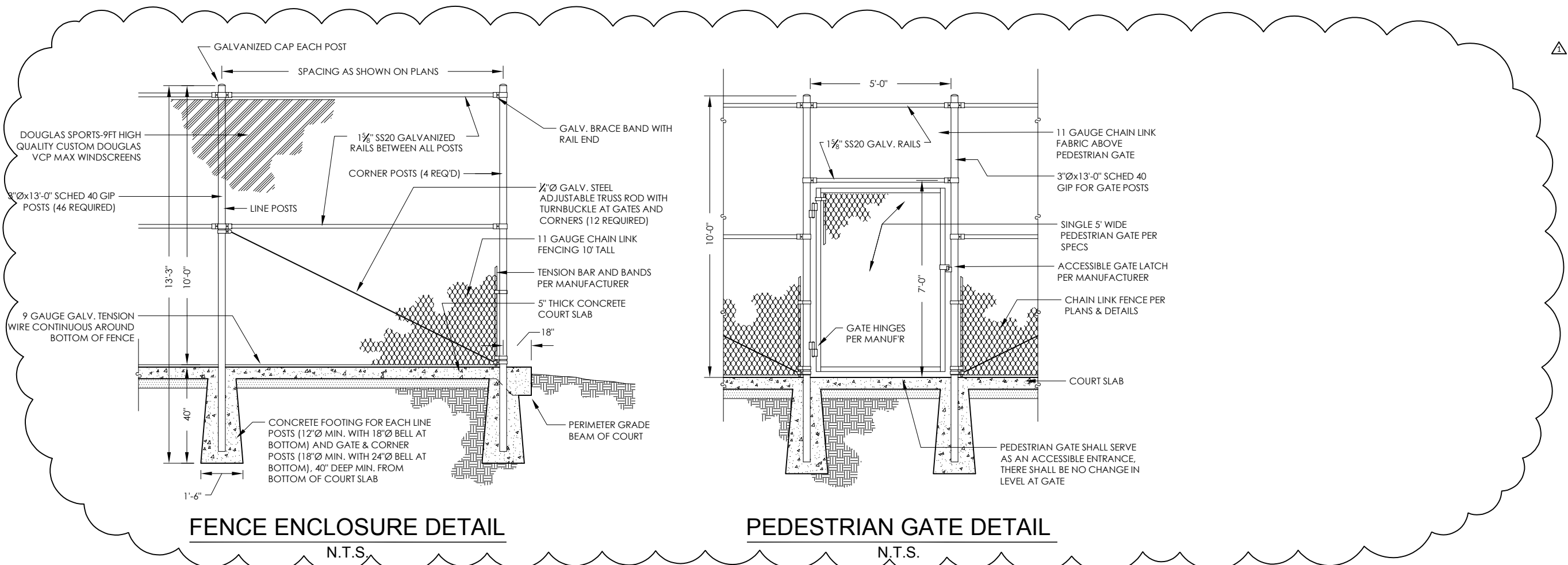
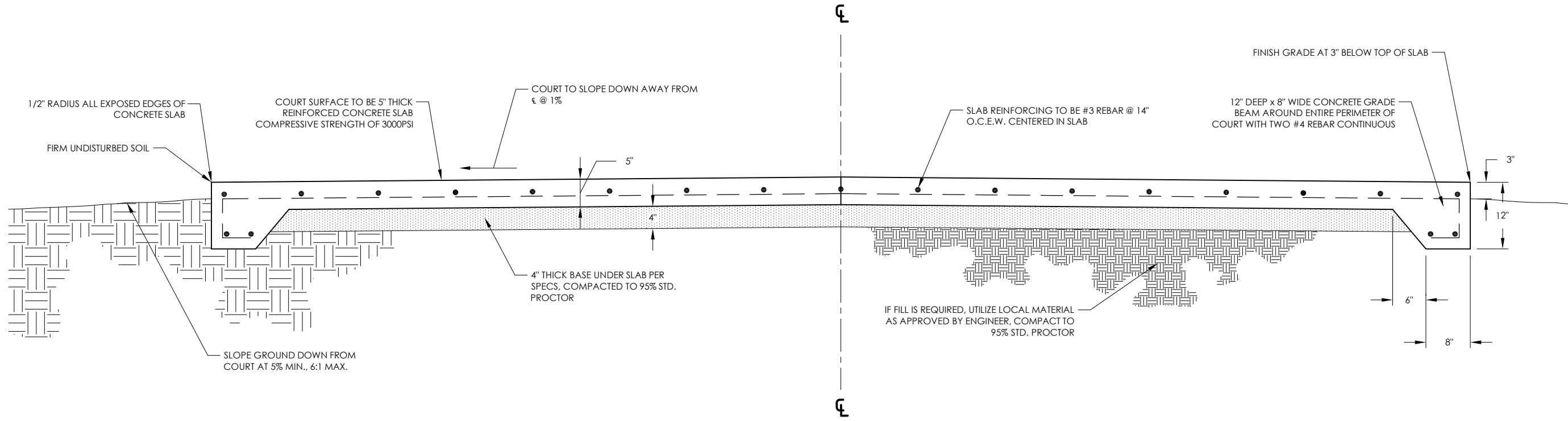

STATE OF TEXAS  
JAMES A. PHILLIPS  
105116  
LICENSED PROFESSIONAL ENGINEER  
08/08/25

ISSUED FOR REVIEW

JACOB MARTIN

TBAE FIRM # 2448

TBPE FIRM # 1019493

CITY OF IDALOU  
2025 - MULTI PURPOSE COURT IMPROVEMENTS  
GENERAL DETAILS

NO.	REVISION	DATE
05	UPDATED FENCE DETAILS	8/27/2025
11		

PROJECT # 25285  
SCALE N.T.S.

BAR IS ONE INCH IN LENGTH ON ORIGINAL DRAWING  
CHECK SCALE AND ADJUST ACCORDINGLY.