

OVERALL 2ND FLOOR PLAN  
SCALE: 1/32" = 1'-0"

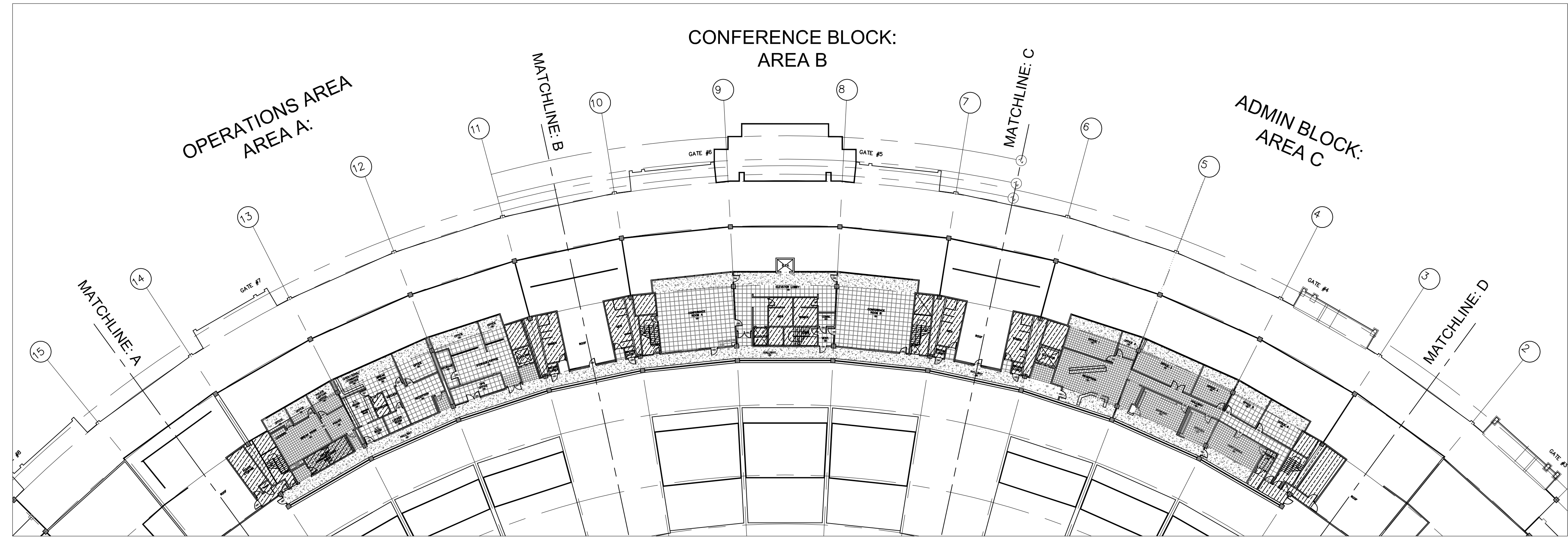

OVERALL 2ND FLOOR RCP  
SCALE: 1/32" = 1'-0"

- NOTES:**
1. ALL WORK TO BE PERFORMED ON THE INTERIOR OF THE BUILDING. NO ROOF, ENVELOPE OR EXTERIOR SCOPE.
  2. ALL GYPSUM WALLS INDICATED AS IN SCOPE, TO BE PAINTED PT-1 UNLESS NOTED OTHERWISE.
  3. ALL EXPOSED AGGREGATE CONCRETE STRUCTURE TO BE PAINTED PT-1 UNLESS NOTED OTHERWISE.
  4. EXPOSED FACES OF PRECAST CONCRETE DOUBLE TEE CEILING STRUCTURES TO BE PAINTED PT-1 UNLESS NOTED OTHERWISE.
  5. ALL DOOR AND DOOR TRIM TO BE PAINTED PT-4.
  6. REFLECTED CEILING PLANS SHOW GENERAL CEILING TYPE AND DO NOT SHOW EXACT LOCATIONS OF EQUIPMENT OR GRIDS.
  7. ALL ELEMENTS WITHIN ACT CEILING TO BE CENTERED WITHIN TILE.
  8. CONTRACTOR TO COORDINATE WITH OWNER ON PROTECTION AND RELOCATION OF FURNITURE AS NECESSARY WITH OWNER DURING CONSTRUCTION.
  9. ALL EXISTING SIGNAGE, EXIT SIGNS, MECHANICAL EQUIPMENT, LIGHTING FIXTURES, DOOR HARDWARE, AND FIRE SPRINKLERS TO BE PROTECTED DURING PAINTING AND CONSTRUCTION.
  10. REFER TO ELECTRICAL AND TECHNOLOGY DRAWINGS FOR MORE INFORMATION.

**LEGEND:**

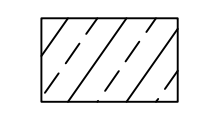
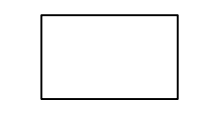
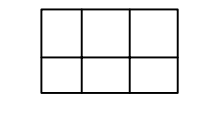
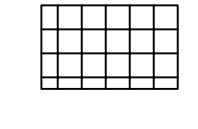
-  AREA NOT IN SCOPE
-  PRECAST CONCRETE CEILING
-  2'x2' ACT CEILING GRID
-  1'x1' ACT CEILING GRID
- PT-X WALL FINISH TAG
- CPT-2 FLOOR FINISH TAG
- 001 ROOM NUMBER
- 001 DOOR TAG

**REVISIONS**

NO.	DESCRIPTION	DATE

DATE ISSUED: 1/24/2025  
REVIEWED BY: KS  
DRAWN BY: AM  
DESIGNED BY: RJ  
PROJECT NUMBER  
**2023184017**  
© 2025 RS&H, INC.  
SHEET TITLE

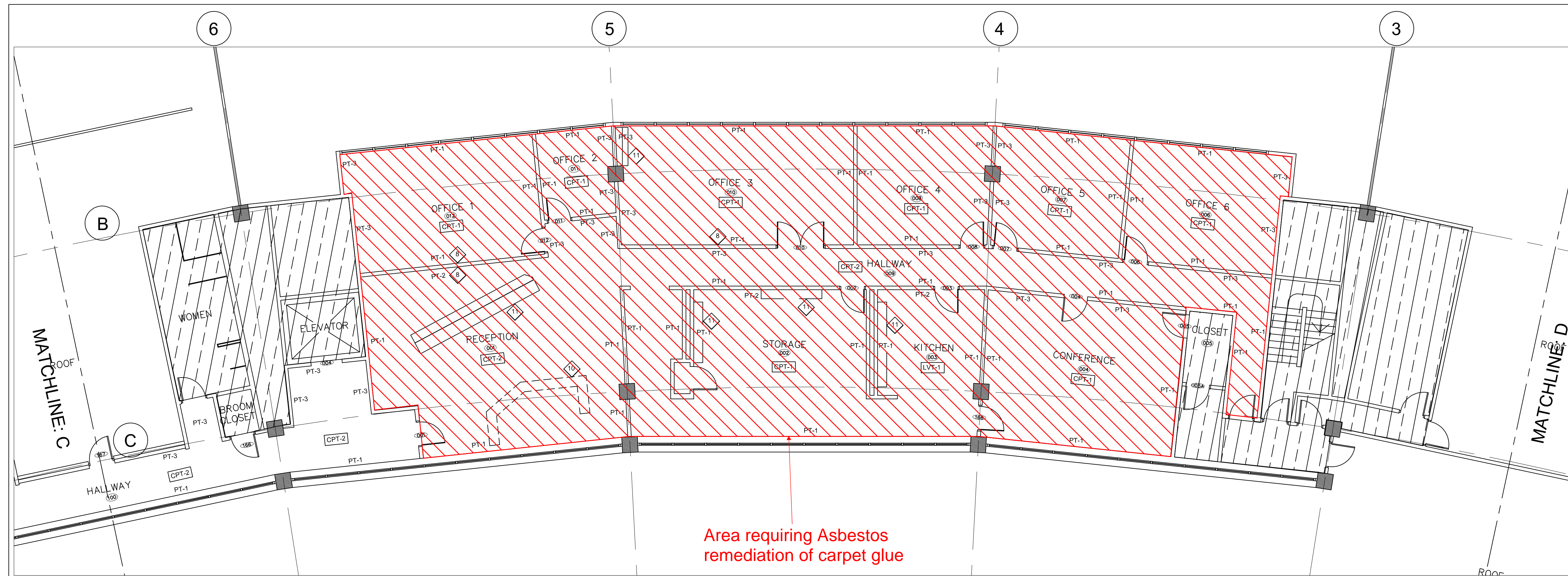

Area requiring Asbestos remediation of carpet glue

ENLARGED 2ND FLOOR PLAN AREA C - ADMIN  
SCALE: 1/8" = 1'-0"

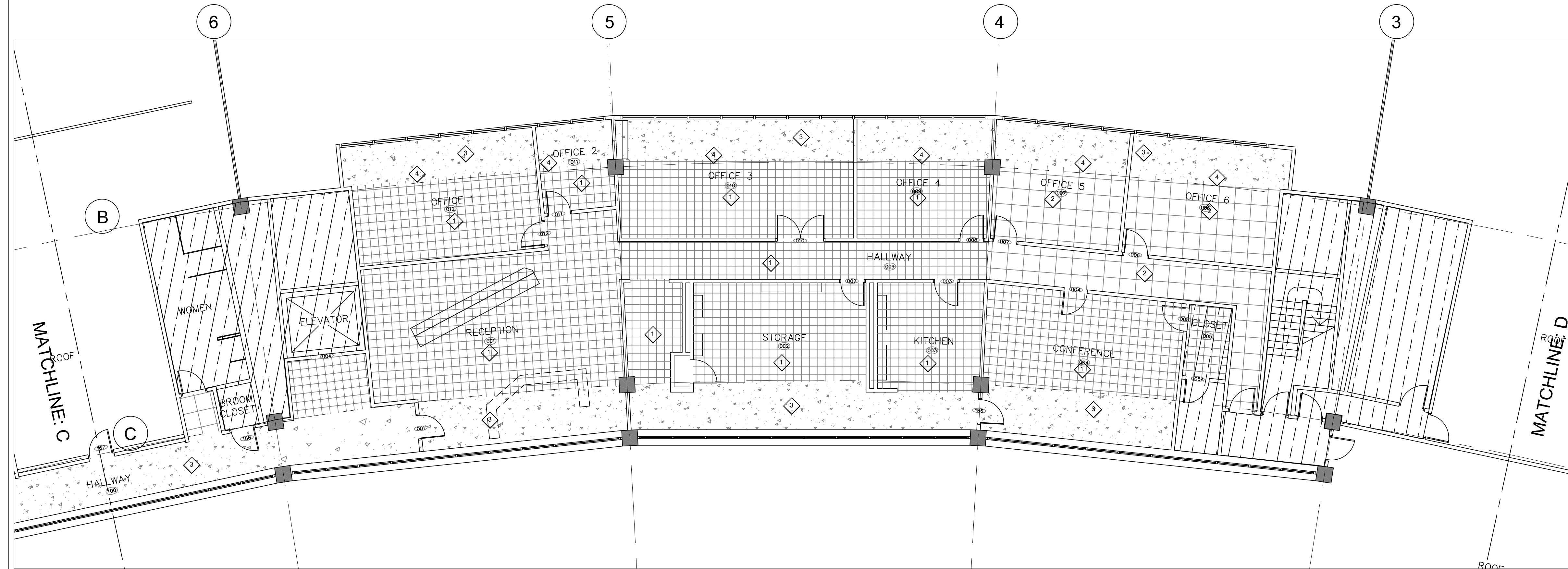

ENLARGED 2ND FLOOR RCP AREA C - ADMIN  
SCALE: 1/8" = 1'-0"

- NOTES:**
1. ALL WORK TO BE PERFORMED ON THE INTERIOR OF THE BUILDING, NO ROOF, ENVELOPE OR EXTERIOR SCOPE.
  2. ALL GYPSUM WALLS INDICATED AS IN SCOPE, TO BE PAINTED PT-1 UNLESS NOTED OTHERWISE.
  3. ALL EXPOSED AGGREGATE CONCRETE STRUCTURE TO BE PAINTED PT-1 UNLESS NOTED OTHERWISE.
  4. EXPOSED FACES OF PRECAST CONCRETE DOUBLE TEE CEILING STRUCTURES TO BE PAINTED PT-1 UNLESS NOTED OTHERWISE.
  5. ALL DOOR AND DOOR TRIM TO BE PAINTED PT-4.
  6. REFLECTED CEILING PLANS SHOW GENERAL CEILING TYPE AND DO NOT SHOW EXACT LOCATIONS OF EQUIPMENT OR GRIDS.
  7. ALL ELEMENTS WITHIN ACT CEILING TO BE CENTERED WITHIN TILE.
  8. CONTRACTOR TO COORDINATE WITH OWNER ON PROTECTION AND RELOCATION OF FURNITURE AS NECESSARY WITH OWNER DURING CONSTRUCTION.
  9. ALL EXISTING SIGNAGE, EXIT SIGNS, MECHANICAL EQUIPMENT, LIGHTING FIXTURES, DOOR HARDWARE, AND FIRE SPRINKLERS TO BE PROTECTED DURING PAINTING AND CONSTRUCTION.
  10. REFER TO ELECTRICAL AND TECHNOLOGY DRAWINGS FOR MORE INFORMATION.

**LEGEND:**

- AREA NOT IN SCOPE
- PRECAST CONCRETE CEILING
- 2'x2' ACT CEILING GRID
- 1'x1' ACT CEILING GRID
- WALL FINISH TAG
- FLOOR FINISH TAG
- ROOM NUMBER
- DOOR TAG

**KEYNOTES:**

- EXISTING 1'x1' CEILING TILES AND GRID SYSTEM TO BE DEMOLISHED AND REPLACED WITH NEW 2'x2' ACT CEILING SYSTEM
- EXISTING 2'x2' CEILING TILES ONLY TO BE REPLACED. EXISTING CEILING GRID TO BE PAINTED AND REPAIR IN PLACE
- EXISTING PRECAST CONCRETE CEILING TO BE PAINTED PT-1
- EXISTING SOFFIT CONDITION OF 1'x1' CEILING TILE TO BE REPLACED WITH GYPSUM WALL BOARD. PAINTED PT-1
- EXISTING WOOD WALL PANELING TO BE DEMOLISHED AND REPLACED WITH PAINTED GYPSUM
- EXISTING MILLWORK TO BE DEMOLISHED
- EXISTING MILLWORK TO BE REFINISHED. PAINTED PT-10A WITH NEW COLOURS



**REVISIONS**

NO.	DESCRIPTION	DATE

DATE ISSUED: 1/24/2025  
REVIEWED BY: KS  
DRAWN BY: AM  
DESIGNED BY: RJ  
PROJECT NUMBER: 2023184017  
© 2025 RS&H, INC.  
SHEET TITLE



2033 HERITAGE PARK DR, OKLAHOMA CITY, OK 73120 | 1.800.822.1650

### Polarized Light Microscopy Asbestos Analysis Report

QuanTEM Lab No. <b>367644</b> Account Number: B370 Date Received: 03/28/2024 Received By: Robin Brady Naik Date Analyzed: 04/01/2024 Analyzed By: Tanner Smith Methodology: EPA/600/R-93/116	Client: City of Lubbock-Facility Maint. Rodney Unrein 1314 Avenue K 4th Fl Lubbock, TX 79457  Project: <b>LIA East Offices/Lobby</b> Project Location: 5401 N MLK BLVD Lubbock TX Project Number: Lubbock International Airport 3rd Floor
--	--

QuanTEM Sample ID	Client Sample ID	Composition	Color / Description	Asbestos (%)	Non-Asbestos Fiber (%)	Non Fibrous
001	CP-1	Layered	Multi-Color Carpet	Asbestos Not Present	Synthetic	30 Binder CaCO3
001a		Layered	Clear Mastic	Asbestos Not Present	NA	Glue
002	CP-2	Layered	Multi-Color Carpet	Asbestos Not Present	Synthetic	30 Binder CaCO3
002a		Layered	Clear Mastic	Asbestos Not Present	NA	Glue
003	CP-3	Layered	Multi-Color Carpet	Asbestos Not Present	Synthetic	30 Binder CaCO3
003a		Layered	Clear Mastic	Asbestos Not Present	NA	Glue
004	CP-4	Layered	Multi-Color Carpet	Asbestos Not Present	Synthetic	30 Binder CaCO3

Unless otherwise noted, upon receipt the condition of the sample was acceptable for analysis.

QuanTEM is a NVLAP accredited Testing PLM laboratory (Lab Code: 101959-0). This report relates only to the specific items tested.  
 NVLAP accreditation applies only to analysis performed utilizing EPA—40 CFR Appendix E to Subpart E of Part 763 and EPA/600/R-93/116 methods.  
 This report may not be used to claim product endorsement by NVLAP or any agency of the US Government.  
 This report may not be reproduced except in full, without the written approval of the laboratory.



2033 HERITAGE PARK DR, OKLAHOMA CITY, OK 73120 | 1.800.822.1650

### Polarized Light Microscopy Asbestos Analysis Report

QuanTEM Lab No. 367644 Account Number: B370 Date Received: 03/28/2024 Received By: Robin Brady Naik Date Analyzed: 04/01/2024 Analyzed By: Tanner Smith Methodology: EPA/600/R-93/116	Client: City of Lubbock-Facility Maint. Rodney Unrein 1314 Avenue K 4th Fl Lubbock, TX 79457  Project: LIA East Offices/Lobby Project Location: 5401 N MLK BLVD Lubbock TX Project Number: Lubbock International Airport 3rd Floor
---	---

QuanTEM Sample ID	Client Sample ID	Composition	Color / Description	Asbestos (%)	Non-Asbestos Fiber (%)	Non Fibrous
004a		Layered	Clear Mastic	Asbestos Not Present	NA	Glue
004b		Layered	Tan/Black Mastic	Asbestos Present Chrysotile <1	NA	Glue Binder
005	CP-5	Layered	Multi-Color Carpet	Asbestos Not Present	Synthetic 30	Binder CaCO3
005a		Layered	Clear Mastic	Asbestos Not Present	NA	Glue
005b		Layered	Tan/Black Mastic	Asbestos Present Chrysotile <1	NA	Glue Binder
006	CP-6	Layered	Multi-Color Carpet	Asbestos Not Present	Synthetic 30	Binder CaCO3

Unless otherwise noted, upon receipt the condition of the sample was acceptable for analysis.

QuanTEM is a NVLAP accredited Testing PLM laboratory (Lab Code: 101959-0). This report relates only to the specific items tested.  
 NVLAP accreditation applies only to analysis performed utilizing EPA—40 CFR Appendix E to Subpart E of Part 763 and EPA/600/R-93/116 methods.  
 This report may not be used to claim product endorsement by NVLAP or any agency of the US Government.  
 This report may not be reproduced except in full, without the written approval of the laboratory.



2033 HERITAGE PARK DR, OKLAHOMA CITY, OK 73120 | 1.800.822.1650

### Polarized Light Microscopy Asbestos Analysis Report

QuanTEM Lab No. 367644 Account Number: B370 Date Received: 03/28/2024 Received By: Robin Brady Naik Date Analyzed: 04/01/2024 Analyzed By: Tanner Smith Methodology: EPA/600/R-93/116	Client: City of Lubbock-Facility Maint. Rodney Unrein 1314 Avenue K 4th Fl Lubbock, TX 79457  Project: LIA East Offices/Lobby Project Location: 5401 N MLK BLVD Lubbock TX Project Number: Lubbock International Airport 3rd Floor
---	---

QuanTEM Sample ID	Client Sample ID	Composition	Color / Description	Asbestos (%)	Non-Asbestos Fiber (%)	Non Fibrous
006a		Layered	Clear Mastic	Asbestos Not Present	NA	Glue
006b		Layered	Tan/Black Mastic	Asbestos Present Chrysotile <1	NA	Glue Binder
007	CP-7	Layered	Brown Cove Base	Asbestos Not Present	NA	Vinyl CaCO3
007a		Layered	Yellow Mastic	Asbestos Not Present	NA	Glue
008	CP-8	Layered	Multi-Color Carpet	Asbestos Not Present	Synthetic 30	Binder CaCO3
008a		Layered	Clear Mastic	Asbestos Not Present	NA	Glue
009	CP-9	Layered	Multi-Color Carpet	Asbestos Not Present	Synthetic 30	Binder CaCO3

Unless otherwise noted, upon receipt the condition of the sample was acceptable for analysis.

QuanTEM is a NVLAP accredited Testing PLM laboratory (Lab Code: 101959-0). This report relates only to the specific items tested.  
 NVLAP accreditation applies only to analysis performed utilizing EPA—40 CFR Appendix E to Subpart E of Part 763 and EPA/600/R-93/116 methods.  
 This report may not be used to claim product endorsement by NVLAP or any agency of the US Government.  
 This report may not be reproduced except in full, without the written approval of the laboratory.



2033 HERITAGE PARK DR, OKLAHOMA CITY, OK 73120 | 1.800.822.1650

### Polarized Light Microscopy Asbestos Analysis Report

QuanTEM Lab No. 367644 Account Number: B370 Date Received: 03/28/2024 Received By: Robin Brady Naik Date Analyzed: 04/01/2024 Analyzed By: Tanner Smith Methodology: EPA/600/R-93/116	Client: City of Lubbock-Facility Maint. Rodney Unrein 1314 Avenue K 4th Fl Lubbock, TX 79457  Project: LIA East Offices/Lobby Project Location: 5401 N MLK BLVD Lubbock TX Project Number: Lubbock International Airport 3rd Floor
---	---

QuanTEM Sample ID	Client Sample ID	Composition	Color / Description	Asbestos (%)	Non-Asbestos Fiber (%)	Non Fibrous
009a		Layered	Clear Mastic	Asbestos Not Present	NA	Glue
010	CP-10	Layered	Multi-Color Carpet	Asbestos Not Present	Synthetic	30 Binder CaCO3
010a		Layered	Clear Mastic	Asbestos Not Present	NA	Glue
010b		Layered	Tan/Black Mastic	Asbestos Present Chrysotile <1	NA	Glue Binder
011	CP-11	Layered	Multi-Color Carpet	Asbestos Not Present	Synthetic	30 Binder CaCO3
011a		Layered	Clear Mastic	Asbestos Not Present	NA	Glue

Unless otherwise noted, upon receipt the condition of the sample was acceptable for analysis.

QuanTEM is a NVLAP accredited Testing PLM laboratory (Lab Code: 101959-0). This report relates only to the specific items tested.  
 NVLAP accreditation applies only to analysis performed utilizing EPA—40 CFR Appendix E to Subpart E of Part 763 and EPA/600/R-93/116 methods.  
 This report may not be used to claim product endorsement by NVLAP or any agency of the US Government.  
 This report may not be reproduced except in full, without the written approval of the laboratory.



2033 HERITAGE PARK DR, OKLAHOMA CITY, OK 73120 | 1.800.822.1650

### Polarized Light Microscopy Asbestos Analysis Report

QuanTEM Lab No. 367644 Account Number: B370 Date Received: 03/28/2024 Received By: Robin Brady Naik Date Analyzed: 04/01/2024 Analyzed By: Tanner Smith Methodology: EPA/600/R-93/116	Client: City of Lubbock-Facility Maint. Rodney Unrein 1314 Avenue K 4th Fl Lubbock, TX 79457  Project: LIA East Offices/Lobby Project Location: 5401 N MLK BLVD Lubbock TX Project Number: Lubbock International Airport 3rd Floor
---	---

QuanTEM Sample ID	Client Sample ID	Composition	Color / Description	Asbestos (%)	Non-Asbestos Fiber (%)	Non Fibrous
011b		Layered	Tan/Black Mastic	Asbestos Present Chrysotile <1	NA	Glue Binder
012	CP-12	Layered	Multi-Color Carpet	Asbestos Not Present	Synthetic	30 Binder CaCO3
012a		Layered	Clear Mastic	Asbestos Not Present	NA	Glue
012b		Layered	Tan/Black Mastic	Asbestos Present Chrysotile <1	NA	Glue Binder
013	CT-1	Homogeneous	White Ceiling Tile	Asbestos Not Present	Cellulose Glass Fiber	50 30 Perlite Paint
014	CT-2	Homogeneous	White Ceiling Tile	Asbestos Not Present	Cellulose Glass Fiber	50 30 Perlite Paint
015	CT-3	Homogeneous	White Ceiling Tile	Asbestos Not Present	Cellulose Glass Fiber	50 30 Perlite Paint

Unless otherwise noted, upon receipt the condition of the sample was acceptable for analysis.

QuanTEM is a NVLAP accredited Testing PLM laboratory (Lab Code: 101959-0). This report relates only to the specific items tested.  
 NVLAP accreditation applies only to analysis performed utilizing EPA—40 CFR Appendix E to Subpart E of Part 763 and EPA/600/R-93/116 methods.  
 This report may not be used to claim product endorsement by NVLAP or any agency of the US Government.  
 This report may not be reproduced except in full, without the written approval of the laboratory.



2033 HERITAGE PARK DR, OKLAHOMA CITY, OK 73120 | 1.800.822.1650

### Polarized Light Microscopy Asbestos Analysis Report

QuanTEM Lab No. 367644 Account Number: B370 Date Received: 03/28/2024 Received By: Robin Brady Naik Date Analyzed: 04/01/2024 Analyzed By: Tanner Smith Methodology: EPA/600/R-93/116	Client: City of Lubbock-Facility Maint. Rodney Unrein 1314 Avenue K 4th Fl Lubbock, TX 79457  Project: LIA East Offices/Lobby Project Location: 5401 N MLK BLVD Lubbock TX Project Number: Lubbock International Airport 3rd Floor
---	---

QuanTEM Sample ID	Client Sample ID	Composition	Color / Description	Asbestos (%)	Non-Asbestos Fiber (%)	Non Fibrous
016	CT-4	Homogeneous	Gray Ceiling Tile	Asbestos Not Present	Glass Fiber 80	Binder Paint
017	CT-5	Homogeneous	Gray Ceiling Tile	Asbestos Not Present	Glass Fiber 80	Binder
018	CT-6	Homogeneous	Gray Ceiling Tile	Asbestos Not Present	Glass Fiber 80	Binder
019	CT-7	Homogeneous	Gray Ceiling Tile	Asbestos Not Present	Glass Fiber 80	Binder Paint
020	CT-8	Homogeneous	Gray Ceiling Tile	Asbestos Not Present	Glass Fiber 80	Binder Paint
021	CT-9	Homogeneous	Gray Ceiling Tile	Asbestos Not Present	Glass Fiber 80	Binder Paint

Unless otherwise noted, upon receipt the condition of the sample was acceptable for analysis.

QuanTEM is a NVLAP accredited Testing PLM laboratory (Lab Code: 101959-0). This report relates only to the specific items tested.  
 NVLAP accreditation applies only to analysis performed utilizing EPA—40 CFR Appendix E to Subpart E of Part 763 and EPA/600/R-93/116 methods.  
 This report may not be used to claim product endorsement by NVLAP or any agency of the US Government.  
 This report may not be reproduced except in full, without the written approval of the laboratory.





2033 HERITAGE PARK DR, OKLAHOMA CITY, OK 73120 | 1.800.822.1650

### Polarized Light Microscopy Asbestos Analysis Report

QuanTEM Lab No. 367644 Account Number: B370 Date Received: 03/28/2024 Received By: Robin Brady Naik Date Analyzed: 04/01/2024 Analyzed By: Tanner Smith Methodology: EPA/600/R-93/116	Client: City of Lubbock-Facility Maint. Rodney Unrein 1314 Avenue K 4th Fl Lubbock, TX 79457  Project: LIA East Offices/Lobby Project Location: 5401 N MLK BLVD Lubbock TX Project Number: Lubbock International Airport 3rd Floor
---	---

QuanTEM Sample ID	Client Sample ID	Composition	Color / Description	Asbestos (%)	Non-Asbestos Fiber (%)	Non Fibrous
022	CB-1	Layered	Purple Cove Base	Asbestos Not Present	NA	Vinyl CaCO3
022a		Layered	Tan Mastic	Asbestos Not Present	NA	Glue
023	CB-2	Layered	Purple Cove Base	Asbestos Not Present	NA	Vinyl CaCO3
023a		Layered	Tan Mastic	Asbestos Not Present	NA	Glue
024	CB-3	Layered	Purple Cove Base	Asbestos Not Present	NA	Vinyl CaCO3
024a		Layered	Tan Mastic	Asbestos Not Present	NA	Glue
025	CB-4	Layered	Purple Cove Base	Asbestos Not Present	NA	Vinyl CaCO3

Unless otherwise noted, upon receipt the condition of the sample was acceptable for analysis.

QuanTEM is a NVLAP accredited Testing PLM laboratory (Lab Code: 101959-0). This report relates only to the specific items tested.  
 NVLAP accreditation applies only to analysis performed utilizing EPA—40 CFR Appendix E to Subpart E of Part 763 and EPA/600/R-93/116 methods.  
 This report may not be used to claim product endorsement by NVLAP or any agency of the US Government.  
 This report may not be reproduced except in full, without the written approval of the laboratory.



2033 HERITAGE PARK DR, OKLAHOMA CITY, OK 73120 | 1.800.822.1650

### Polarized Light Microscopy Asbestos Analysis Report

QuantEM Lab No. 367644	Client: City of Lubbock-Facility Maint.
Account Number: B370	Rodney Unrein
Date Received: 03/28/2024	1314 Avenue K 4th Fl
Received By: Robin Brady Naik	Lubbock, TX 79457
Date Analyzed: 04/01/2024	Project: LIA East Offices/Lobby
Analyzed By: Tanner Smith	Project Location: 5401 N MLK BLVD Lubbock TX
Methodology: EPA/600/R-93/116	Project Number: Lubbock International Airport 3rd Floor

QuanTEM Sample ID	Client Sample ID	Composition	Color / Description	Asbestos (%)	Non-Asbestos Fiber (%)	Non Fibrous
025a		Layered	Tan Mastic	Asbestos Not Present	NA	Glue
025b		Layered	Black Mastic	Asbestos Not Present	NA	Glue Binder
025c		Layered	Gray Skim Coat	Asbestos Not Present	NA	CaCO3 Sand Paint
026	CB-5	Layered	Purple Cove Base	Asbestos Not Present	NA	Vinyl CaCO3
026a		Layered	Tan Mastic	Asbestos Not Present	NA	Glue
027	CB-6	Layered	Purple Cove Base	Asbestos Not Present	NA	Vinyl CaCO3

Unless otherwise noted, upon receipt the condition of the sample was acceptable for analysis.

QuantEM is a NVLAP accredited Testing PLM laboratory (Lab Code: 101959-0). This report relates only to the specific items tested. NVLAP accreditation applies only to analysis performed utilizing EPA—40 CFR Appendix E to Subpart E of Part 763 and EPA/600/R-93/116 methods. This report may not be used to claim product endorsement by NVLAP or any agency of the US Government. This report may not be reproduced except in full, without the written approval of the laboratory.



2033 HERITAGE PARK DR, OKLAHOMA CITY, OK 73120 | 1.800.822.1650

### Polarized Light Microscopy Asbestos Analysis Report

QuanTEM Lab No. 367644 Account Number: B370 Date Received: 03/28/2024 Received By: Robin Brady Naik Date Analyzed: 04/01/2024 Analyzed By: Tanner Smith Methodology: EPA/600/R-93/116	Client: City of Lubbock-Facility Maint. Rodney Unrein 1314 Avenue K 4th Fl Lubbock, TX 79457  Project: LIA East Offices/Lobby Project Location: 5401 N MLK BLVD Lubbock TX Project Number: Lubbock International Airport 3rd Floor
---	---

QuanTEM Sample ID	Client Sample ID	Composition	Color / Description	Asbestos (%)	Non-Asbestos Fiber (%)	Non Fibrous
027a		Layered	Tan Mastic	Asbestos Not Present	NA	Glue
027b		Layered	Black Mastic	Asbestos Not Present	NA	Glue Binder
027c		Layered	Gray Skim Coat	Asbestos Not Present	NA	CaCO3 Sand Paint
028	CB-7	Layered	Brown Cove Base	Asbestos Not Present	NA	Vinyl CaCO3
028a		Layered	Tan Mastic	Asbestos Not Present	NA	Glue
028b		Layered	Black Mastic	Asbestos Not Present	NA	Glue Binder
028c		Layered	White Wall Paper	Asbestos Not Present	Cellulose 10 Synthetic 40	Binder

Unless otherwise noted, upon receipt the condition of the sample was acceptable for analysis.

QuanTEM is a NVLAP accredited Testing PLM laboratory (Lab Code: 101959-0). This report relates only to the specific items tested.  
 NVLAP accreditation applies only to analysis performed utilizing EPA—40 CFR Appendix E to Subpart E of Part 763 and EPA/600/R-93/116 methods.  
 This report may not be used to claim product endorsement by NVLAP or any agency of the US Government.  
 This report may not be reproduced except in full, without the written approval of the laboratory.



2033 HERITAGE PARK DR, OKLAHOMA CITY, OK 73120 | 1.800.822.1650

### Polarized Light Microscopy Asbestos Analysis Report

QuanTEM Lab No. 367644 Account Number: B370 Date Received: 03/28/2024 Received By: Robin Brady Naik Date Analyzed: 04/01/2024 Analyzed By: Tanner Smith Methodology: EPA/600/R-93/116	Client: City of Lubbock-Facility Maint. Rodney Unrein 1314 Avenue K 4th Fl Lubbock, TX 79457  Project: LIA East Offices/Lobby Project Location: 5401 N MLK BLVD Lubbock TX Project Number: Lubbock International Airport 3rd Floor
---	---

QuanTEM Sample ID	Client Sample ID	Composition	Color / Description	Asbestos (%)	Non-Asbestos Fiber (%)	Non Fibrous
028d		Layered	Cream Mastic	Asbestos Not Present	NA	Binder CaCO3
029	CB-8	Layered	Brown Cove Base	Asbestos Not Present	NA	Vinyl CaCO3
029a		Layered	Tan Mastic	Asbestos Not Present	NA	Glue
029b		Layered	Black Mastic	Asbestos Not Present	NA	Glue Binder
029c		Layered	White Wall Paper	Asbestos Not Present	Cellulose 10 Synthetic 40	Binder
029d		Layered	Cream Mastic	Asbestos Not Present	NA	Binder CaCO3

Unless otherwise noted, upon receipt the condition of the sample was acceptable for analysis.

QuanTEM is a NVLAP accredited Testing PLM laboratory (Lab Code: 101959-0). This report relates only to the specific items tested.  
 NVLAP accreditation applies only to analysis performed utilizing EPA—40 CFR Appendix E to Subpart E of Part 763 and EPA/600/R-93/116 methods.  
 This report may not be used to claim product endorsement by NVLAP or any agency of the US Government.  
 This report may not be reproduced except in full, without the written approval of the laboratory.



2033 HERITAGE PARK DR, OKLAHOMA CITY, OK 73120 | 1.800.822.1650

### Polarized Light Microscopy Asbestos Analysis Report

QuanTEM Lab No. 367644 Account Number: B370 Date Received: 03/28/2024 Received By: Robin Brady Naik Date Analyzed: 04/01/2024 Analyzed By: Tanner Smith Methodology: EPA/600/R-93/116	Client: City of Lubbock-Facility Maint. Rodney Unrein 1314 Avenue K 4th Fl Lubbock, TX 79457  Project: LIA East Offices/Lobby Project Location: 5401 N MLK BLVD Lubbock TX Project Number: Lubbock International Airport 3rd Floor
---	---

QuanTEM Sample ID	Client Sample ID	Composition	Color / Description	Asbestos (%)	Non-Asbestos Fiber (%)	Non Fibrous
030	CB-9	Layered	Brown Cove Base	Asbestos Not Present	NA	Vinyl CaCO3
030a		Layered	Tan Mastic	Asbestos Not Present	NA	Glue
030b		Layered	Black Mastic	Asbestos Not Present	NA	Glue Binder
030c		Layered	White Wall Paper	Asbestos Not Present	Cellulose 10 Synthetic 40	Binder
030d		Layered	Cream Mastic	Asbestos Not Present	NA	Binder CaCO3
031	DW-1	Homogeneous	Peach Drywall	Asbestos Not Present	Cellulose 5 Glass Fiber <1	Gypsum
032	DW-2	Layered	White Texture	Asbestos Not Present	NA	CaCO3 Paint

Unless otherwise noted, upon receipt the condition of the sample was acceptable for analysis.

QuanTEM is a NVLAP accredited Testing PLM laboratory (Lab Code: 101959-0). This report relates only to the specific items tested.  
 NVLAP accreditation applies only to analysis performed utilizing EPA—40 CFR Appendix E to Subpart E of Part 763 and EPA/600/R-93/116 methods.  
 This report may not be used to claim product endorsement by NVLAP or any agency of the US Government.  
 This report may not be reproduced except in full, without the written approval of the laboratory.



2033 HERITAGE PARK DR, OKLAHOMA CITY, OK 73120 | 1.800.822.1650

### Polarized Light Microscopy Asbestos Analysis Report

QuanTEM Lab No. 367644 Account Number: B370 Date Received: 03/28/2024 Received By: Robin Brady Naik Date Analyzed: 04/01/2024 Analyzed By: Tanner Smith Methodology: EPA/600/R-93/116	Client: City of Lubbock-Facility Maint. Rodney Unrein 1314 Avenue K 4th Fl Lubbock, TX 79457  Project: LIA East Offices/Lobby Project Location: 5401 N MLK BLVD Lubbock TX Project Number: Lubbock International Airport 3rd Floor
---	---

QuanTEM Sample ID	Client Sample ID	Composition	Color / Description	Asbestos (%)	Non-Asbestos Fiber (%)	Non Fibrous
032a		Layered	Peach Drywall	Asbestos Not Present	Cellulose 15 Glass Fiber <1	Gypsum
033	DW-3	Layered	White Texture	Asbestos Not Present	NA	CaCO3 Paint
033a		Layered	Peach Drywall	Asbestos Not Present	Cellulose 10 Glass Fiber <1	Gypsum
034	DW-4	Layered	White Texture	Asbestos Not Present	NA	CaCO3 Paint
034a		Layered	White Wall Paper	Asbestos Not Present	Cellulose 10 Synthetic 40	Binder
034b		Layered	Cream Mastic	Asbestos Not Present	NA	Binder CaCO3

Unless otherwise noted, upon receipt the condition of the sample was acceptable for analysis.

QuanTEM is a NVLAP accredited Testing PLM laboratory (Lab Code: 101959-0). This report relates only to the specific items tested.  
 NVLAP accreditation applies only to analysis performed utilizing EPA—40 CFR Appendix E to Subpart E of Part 763 and EPA/600/R-93/116 methods.  
 This report may not be used to claim product endorsement by NVLAP or any agency of the US Government.  
 This report may not be reproduced except in full, without the written approval of the laboratory.



2033 HERITAGE PARK DR, OKLAHOMA CITY, OK 73120 | 1.800.822.1650

### Polarized Light Microscopy Asbestos Analysis Report

Quantem Lab No. 367644	Client: City of Lubbock-Facility Maint.
Account Number: B370	Rodney Unrein
Date Received: 03/28/2024	1314 Avenue K 4th Fl
Received By: Robin Brady Naik	Lubbock, TX 79457
Date Analyzed: 04/01/2024	Project: LIA East Offices/Lobby
Analyzed By: Tanner Smith	Project Location: 5401 N MLK BLVD Lubbock TX
Methodology: EPA/600/R-93/116	Project Number: Lubbock International Airport 3rd Floor

QuanTEM Sample ID	Client Sample ID	Composition	Color / Description	Asbestos (%)	Non-Asbestos Fiber (%)	Non Fibrous
034c		Layered	White Drywall	Asbestos Not Present	Cellulose 15 Glass Fiber 2	Gypsum
035	DW-5	Layered	White Texture	Asbestos Not Present	NA	CaCO3 Paint
035a		Layered	White Wall Paper	Asbestos Not Present	Cellulose 10 Synthetic 40	Binder
035b		Layered	Cream Mastic	Asbestos Not Present	NA	Binder CaCO3
035c		Layered	White Drywall	Asbestos Not Present	Cellulose 15 Glass Fiber 2	Gypsum
036	DW-6	Layered	White Texture	Asbestos Not Present	NA	CaCO3 Paint
036a		Layered	White Wall Paper	Asbestos Not Present	Cellulose 10 Synthetic 40	Binder

Unless otherwise noted, upon receipt the condition of the sample was acceptable for analysis.

Quantem is a NVLAP accredited Testing PLM laboratory (Lab Code: 101959-0). This report relates only to the specific items tested. NVLAP accreditation applies only to analysis performed utilizing EPA—40 CFR Appendix E to Subpart E of Part 763 and EPA/600/R-93/116 methods. This report may not be used to claim product endorsement by NVLAP or any agency of the US Government. This report may not be reproduced except in full, without the written approval of the laboratory.



2033 HERITAGE PARK DR, OKLAHOMA CITY, OK 73120 | 1.800.822.1650

### Polarized Light Microscopy Asbestos Analysis Report

QuanTEM Lab No. 367644 Account Number: B370 Date Received: 03/28/2024 Received By: Robin Brady Naik Date Analyzed: 04/01/2024 Analyzed By: Tanner Smith Methodology: EPA/600/R-93/116	Client: City of Lubbock-Facility Maint. Rodney Unrein 1314 Avenue K 4th Fl Lubbock, TX 79457  Project: LIA East Offices/Lobby Project Location: 5401 N MLK BLVD Lubbock TX Project Number: Lubbock International Airport 3rd Floor
---	---

QuanTEM Sample ID	Client Sample ID	Composition	Color / Description	Asbestos (%)	Non-Asbestos Fiber (%)	Non Fibrous
036b		Layered	Cream Mastic	Asbestos Not Present	NA	Binder CaCO3
036c		Layered	White Drywall	Asbestos Not Present	Cellulose Glass Fiber	15 2 Gypsum
037	DW-7	Layered	White Texture	Asbestos Not Present	NA	CaCO3 Paint
037a		Layered	White Wall Paper	Asbestos Not Present	Cellulose Synthetic	10 40 Binder
037b		Layered	Cream Mastic	Asbestos Not Present	NA	Binder CaCO3
037c		Layered	White Drywall	Asbestos Not Present	Cellulose Glass Fiber	15 2 Gypsum

Unless otherwise noted, upon receipt the condition of the sample was acceptable for analysis.

QuanTEM is a NVLAP accredited Testing PLM laboratory (Lab Code: 101959-0). This report relates only to the specific items tested.  
 NVLAP accreditation applies only to analysis performed utilizing EPA—40 CFR Appendix E to Subpart E of Part 763 and EPA/600/R-93/116 methods.  
 This report may not be used to claim product endorsement by NVLAP or any agency of the US Government.  
 This report may not be reproduced except in full, without the written approval of the laboratory.





2033 HERITAGE PARK DR, OKLAHOMA CITY, OK 73120 | 1.800.822.1650

### Polarized Light Microscopy Asbestos Analysis Report

QuanTEM Lab No. 367644 Account Number: B370 Date Received: 03/28/2024 Received By: Robin Brady Naik Date Analyzed: 04/01/2024 Analyzed By: Tanner Smith Methodology: EPA/600/R-93/116	Client: City of Lubbock-Facility Maint. Rodney Unrein 1314 Avenue K 4th Fl Lubbock, TX 79457  Project: LIA East Offices/Lobby Project Location: 5401 N MLK BLVD Lubbock TX Project Number: Lubbock International Airport 3rd Floor
---	---

QuanTEM Sample ID	Client Sample ID	Composition	Color / Description	Asbestos (%)	Non-Asbestos Fiber (%)	Non Fibrous
038	DW-8	Layered	White Texture	Asbestos Not Present	NA	CaCO3 Paint
038a		Layered	White Wall Paper	Asbestos Not Present	Cellulose 10 Synthetic 40	Binder
038b		Layered	Cream Mastic	Asbestos Not Present	NA	Binder CaCO3
038c		Layered	White Drywall	Asbestos Not Present	Cellulose 15 Glass Fiber 2	Gypsum
039	DW-9	Layered	White Texture	Asbestos Not Present	NA	CaCO3 Paint
039a		Layered	White Wall Paper	Asbestos Not Present	Cellulose 10 Synthetic 40	Binder
039b		Layered	Cream Mastic	Asbestos Not Present	NA	Binder CaCO3

Unless otherwise noted, upon receipt the condition of the sample was acceptable for analysis.

QuanTEM is a NVLAP accredited Testing PLM laboratory (Lab Code: 101959-0). This report relates only to the specific items tested.  
 NVLAP accreditation applies only to analysis performed utilizing EPA—40 CFR Appendix E to Subpart E of Part 763 and EPA/600/R-93/116 methods.  
 This report may not be used to claim product endorsement by NVLAP or any agency of the US Government.  
 This report may not be reproduced except in full, without the written approval of the laboratory.



2033 HERITAGE PARK DR, OKLAHOMA CITY, OK 73120 | 1.800.822.1650

### Polarized Light Microscopy Asbestos Analysis Report

QuantEM Lab No. 367644	Client: City of Lubbock-Facility Maint.
Account Number: B370	Rodney Unrein
Date Received: 03/28/2024	1314 Avenue K 4th Fl
Received By: Robin Brady Naik	Lubbock, TX 79457
Date Analyzed: 04/01/2024	Project: LIA East Offices/Lobby
Analyzed By: Tanner Smith	Project Location: 5401 N MLK BLVD Lubbock TX
Methodology: EPA/600/R-93/116	Project Number: Lubbock International Airport 3rd Floor

QuantEM Sample ID	Client Sample ID	Composition	Color / Description	Asbestos (%)	Non-Asbestos Fiber (%)	Non Fibrous
039c		Layered	White Drywall	Asbestos Not Present	Cellulose 15 Glass Fiber 2	Gypsum 2

\_\_\_\_\_  
Tanner Smith, Laboratory Analyst

\_\_\_\_\_  
4/3/2024

\_\_\_\_\_  
Date of Report

Unless otherwise noted, upon receipt the condition of the sample was acceptable for analysis.

QuantEM is a NVLAP accredited Testing PLM laboratory (Lab Code: 101959-0). This report relates only to the specific items tested. NVLAP accreditation applies only to analysis performed utilizing EPA—40 CFR Appendix E to Subpart E of Part 763 and EPA/600/R-93/116 methods. This report may not be used to claim product endorsement by NVLAP or any agency of the US Government. This report may not be reproduced except in full, without the written approval of the laboratory.



# ASBESTOS CHAIN OF CUSTODY

2033 Heritage Park Drive, Oklahoma City, OK 73120-7502  
 (800) 822-1650 • (405) 755-7272 • Fax: (405) 755-2058

## LEGAL DOCUMENT - PLEASE PRINT LEGIBLY

For Lab Use Only	
Lab No. <u>367644</u>	Accept <input type="checkbox"/> Reject <input type="checkbox"/>
Report Results <input checked="" type="checkbox"/> one box	
<input type="checkbox"/> QuanTEM Website	<input checked="" type="checkbox"/> Other_email

Contact Information		Project Information	
Company: City of Lubbock	Phone: (806) 470-4125	Project Name: LIA East Offices / Lobby	
Contact: Rodney Unrein	Cell Phone: (806) 470-4125	Project Location: 5401 N. MLK BLVD., Lubbock, TX.	
Account #: B370	E-mail: runrein@myLubbock.us	Project ID: Lubbock International Airport 3rd Floor	
SAMPLED BY: Name: Rodney Unrein	Date: 03/26/2023	P.O. Number: 3262024	

RELINQUISHED BY: <u>Rodney Unrein</u>	VIA: <u>FedEx</u>	RECEIVED BY: <u>CBW</u>	DATE & TIME: <u>3/28/24</u>
			<u>9:50</u>

REQUESTED SERVICES (Please  the Appropriate Boxes)

PLM	PLM	TEM	TEM	TURNAROUND TIME
<input checked="" type="checkbox"/> Bulk Analysis (EPA 600/R-93/116)	<input type="checkbox"/> Vermiculite Attic Insulation (EPA 600/R-04/004)	<input type="checkbox"/> Air- AHERA	<input type="checkbox"/> Bulk- Presence / Absence EPA600/R-93/116	<input type="checkbox"/> Rush
<input type="checkbox"/> 400 Point Count	<input type="checkbox"/> Other	<input type="checkbox"/> Air- NIOSH 7402	<input type="checkbox"/> Bulk- Quantitative [weight%]- Chatfield	<input type="checkbox"/> Same Day
<input type="checkbox"/> 1000 Point Count		<input type="checkbox"/> Air- ISO 10312	<input type="checkbox"/> Dust- Presence / Absence	<input type="checkbox"/> 24 - Hour
<input type="checkbox"/> Gravimetric Preparation	PCM	<input type="checkbox"/> Drinking Water- EPA 100.2	<input type="checkbox"/> Dust- Quantitative [fibers/sq.cm]- ASTM D5755	<input type="checkbox"/> 3 - Day
<input type="checkbox"/> Particle ID	NIOSH 7400	<input type="checkbox"/> Waste Water- EPA 600/4-83-043	Other	<input checked="" type="checkbox"/> 5 - Day

No.	Sample ID (10 Characters Max)	To Be Analyzed <input checked="" type="checkbox"/>	Color	Description	Volume / Area (as applicable)	Comments / Notes
1	CP-1	<input checked="" type="checkbox"/>	Blue / Orange	Carpet		+ stop
2	CP-2	<input checked="" type="checkbox"/>	Blue / Orange	Carpet		↓
3	CP-3	<input checked="" type="checkbox"/>	Blue / Orange	Carpet		+ stop
4	CP-4	<input checked="" type="checkbox"/>	Blue / Orange	Carpet		↓
5	CP-5	<input checked="" type="checkbox"/>	Grey / Tan	Carpet		+ stop
6	CP-6	<input checked="" type="checkbox"/>	Grey / Tan	Carpet		↓
7	CP-7	<input checked="" type="checkbox"/>	Grey / Orange	Carpet		+ stop
8	CP-8	<input checked="" type="checkbox"/>	Grey / Orange	Carpet		↓
9	CP-9	<input checked="" type="checkbox"/>	Grey / Orange	Carpet		+ stop
10	CP-10	<input checked="" type="checkbox"/>	Grey / Orange	Carpet		+ stop





# ASBESTOS CHAIN OF CUSTODY

2033 Heritage Park Drive, Oklahoma City, OK 73120-7502  
 (800) 822-1650 • (405) 755-7272 • Fax: (405) 755-2058

**LEGAL DOCUMENT - PLEASE PRINT LEGIBLY**

For Lab Use Only
Lab No. <u>367644</u>
Accept <input type="checkbox"/> Reject <input type="checkbox"/>

Project Information		Project Name:	Project Location:	Volume / Area (as applicable)	Comments / Notes	
Company: City Of Lubbock		LIA East Offices / Lobby	5401 N. MLK BLVD., Lubbock, TX.			
No.	Sample ID (10 Characters Max)	<input checked="" type="checkbox"/> To Be Analyzed	Color	Description	Volume / Area (as applicable)	Comments / Notes
11	CP-11	<input checked="" type="checkbox"/>	↓	↓		↓
12	CP-12	<input checked="" type="checkbox"/>				
13	CT-1	<input checked="" type="checkbox"/>	White	Ceiling Tile		+ stop
14	CT-2	<input checked="" type="checkbox"/>	↓	↓		↓
15	CT-3	<input checked="" type="checkbox"/>				
16	CT-4	<input checked="" type="checkbox"/>	Grey	Ceiling Tile		+ stop
17	CT-5	<input checked="" type="checkbox"/>	↓	↓		↓
18	CT-6	<input checked="" type="checkbox"/>				
19	CT-7	<input checked="" type="checkbox"/>	White / Grey	Ceiling Tile		+ stop
20	CT-8	<input checked="" type="checkbox"/>	↓	↓		↓
21	CT-9	<input checked="" type="checkbox"/>				
22	CB-1	<input checked="" type="checkbox"/>	Maroon	Cove Base		+ stop
23	CB-2	<input checked="" type="checkbox"/>	↓	↓		↓
24	CB-3	<input checked="" type="checkbox"/>				
25	CB-4	<input checked="" type="checkbox"/>	Maroon	Cove Base		+ stop
26	CB-5	<input checked="" type="checkbox"/>	↓	↓		↓
27	CB-6	<input checked="" type="checkbox"/>				
28	CB-7	<input checked="" type="checkbox"/>	Dark Brown	Cove Base		+ stop
29	CB-8	<input checked="" type="checkbox"/>	↓	↓		↓
30	CB-9	<input checked="" type="checkbox"/>				





# ASBESTOS CHAIN OF CUSTODY

2033 Heritage Park Drive, Oklahoma City, OK 73120-7502  
 (800) 822-1650 • (405) 755-7272 • Fax: (405) 755-2058

**LEGAL DOCUMENT - PLEASE PRINT LEGIBLY**

For Lab Use Only	
Lab No. <u>267644</u>	Accept <input type="checkbox"/> Reject <input type="checkbox"/>

Project Information		Project Name:	Project Location:	Volume / Area (as applicable)	Comments / Notes	
Company: City Of Lubbock		LIA East Offices / Lobby	5401 N. MLK BLVD., Lubbock, TX.			
No.	Sample ID (10 Characters Max)	To Be Analyzed	Color	Description	Volume / Area (as applicable)	Comments / Notes
31	DW-1	<input checked="" type="checkbox"/>	White	Drywall		+ stop
32	DW-2	<input checked="" type="checkbox"/>	↓	↓		↓
33	DW-3	<input checked="" type="checkbox"/>	White	Drywall		+ stop
34	DW-4	<input checked="" type="checkbox"/>	↓	↓		↓
35	DW-5	<input checked="" type="checkbox"/>	White	Drywall		+ stop
36	DW-6	<input checked="" type="checkbox"/>	↓	↓		↓
37	DW-7	<input checked="" type="checkbox"/>	White	Drywall		+ stop
38	DW-8	<input checked="" type="checkbox"/>	↓	↓		↓
39	DW-9	<input checked="" type="checkbox"/>				
40		<input type="checkbox"/>				+ stop
41		<input type="checkbox"/>				
42		<input type="checkbox"/>				
43		<input type="checkbox"/>				+ stop
44		<input type="checkbox"/>				
45		<input type="checkbox"/>				
46		<input type="checkbox"/>				+ stop
47		<input type="checkbox"/>				
48		<input type="checkbox"/>				
49		<input type="checkbox"/>				+ stop
50		<input type="checkbox"/>				



2033 HERITAGE PARK DR, OKLAHOMA CITY, OK 73120 | 1.800.822.1650

### Polarized Light Microscopy Asbestos Analysis Report

QuanTEM Lab No. <b>367643</b> Account Number: B370 Date Received: 03/28/2024 Received By: Baylie Longstreth Date Analyzed: 04/03/2024 Analyzed By: Cassie Sanborn Methodology: EPA/600/R-93/116	Client: City of Lubbock-Facility Maint. Rodney Unrein 1314 Avenue K 4th Fl Lubbock, TX 79457  Project: <b>LIA Police Offices / Breakroom</b> Project Location: 5401 MLK Blvd., Lubbock, TX Project Number: Police Offices / Breakroom
---	--

QuanTEM Sample ID	Client Sample ID	Composition	Color / Description	Asbestos (%)	Non-Asbestos Fiber (%)	Non Fibrous
001	DW-1	Homogeneous	White Drywall	Asbestos Not Present	Cellulose Glass Fiber	10 2 Gypsum Mica
002	DW-2	Homogeneous	White Drywall	Asbestos Not Present	Cellulose Glass Fiber	10 2 Gypsum Mica
003	DW-3	Homogeneous	White Drywall	Asbestos Not Present	Cellulose Glass Fiber	10 2 Gypsum Mica
004	CP-1	Layered	Blue Carpet	Asbestos Not Present	Synthetic	90 Binder
004a		Layered	Yellow/Black Mastic	Asbestos Not Present	NA	Glue CaCO3
005	CP-2	Layered	Blue Carpet	Asbestos Not Present	Synthetic	90 Binder
005a		Layered	Yellow Mastic	Asbestos Not Present	NA	Glue CaCO3

Unless otherwise noted, upon receipt the condition of the sample was acceptable for analysis.

QuanTEM is a NVLAP accredited Testing PLM laboratory (Lab Code: 101959-0). This report relates only to the specific items tested.  
 NVLAP accreditation applies only to analysis performed utilizing EPA—40 CFR Appendix E to Subpart E of Part 763 and EPA/600/R-93/116 methods.  
 This report may not be used to claim product endorsement by NVLAP or any agency of the US Government.  
 This report may not be reproduced except in full, without the written approval of the laboratory.



2033 HERITAGE PARK DR, OKLAHOMA CITY, OK 73120 | 1.800.822.1650

### Polarized Light Microscopy Asbestos Analysis Report

QuanTEM Lab No. 367643 Account Number: B370 Date Received: 03/28/2024 Received By: Baylie Longstreth Date Analyzed: 04/03/2024 Analyzed By: Cassie Sanborn Methodology: EPA/600/R-93/116	Client: City of Lubbock-Facility Maint. Rodney Unrein 1314 Avenue K 4th Fl Lubbock, TX 79457  Project: LIA Police Offices / Breakroom Project Location: 5401 MLK Blvd., Lubbock, TX Project Number: Police Offices / Breakroom
--	---

QuanTEM Sample ID	Client Sample ID	Composition	Color / Description	Asbestos (%)	Non-Asbestos Fiber (%)	Non Fibrous
006	CP-3	Layered	Blue Carpet	Asbestos Not Present	Synthetic 90	Binder
006a		Layered	Yellow Mastic	Asbestos Not Present	NA	Glue CaCO3
007	CB-1	Layered	Blue Cove Base	Asbestos Not Present	NA	CaCO3 Vinyl
007a		Layered	Tan Mastic	Asbestos Not Present	NA	Glue CaCO3
007b		Layered	White Surfacing	Asbestos Not Present	NA	CaCO3
007c		Layered	Brown Mastic	Asbestos Not Present	NA	Glue

Unless otherwise noted, upon receipt the condition of the sample was acceptable for analysis.

QuanTEM is a NVLAP accredited Testing PLM laboratory (Lab Code: 101959-0). This report relates only to the specific items tested.  
 NVLAP accreditation applies only to analysis performed utilizing EPA—40 CFR Appendix E to Subpart E of Part 763 and EPA/600/R-93/116 methods.  
 This report may not be used to claim product endorsement by NVLAP or any agency of the US Government.  
 This report may not be reproduced except in full, without the written approval of the laboratory.



2033 HERITAGE PARK DR, OKLAHOMA CITY, OK 73120 | 1.800.822.1650

### Polarized Light Microscopy Asbestos Analysis Report

QuanTEM Lab No. 367643 Account Number: B370 Date Received: 03/28/2024 Received By: Baylie Longstreth Date Analyzed: 04/03/2024 Analyzed By: Cassie Sanborn Methodology: EPA/600/R-93/116	Client: City of Lubbock-Facility Maint. Rodney Unrein 1314 Avenue K 4th Fl Lubbock, TX 79457  Project: LIA Police Offices / Breakroom Project Location: 5401 MLK Blvd., Lubbock, TX Project Number: Police Offices / Breakroom
--	---

QuanTEM Sample ID	Client Sample ID	Composition	Color / Description	Asbestos (%)	Non-Asbestos Fiber (%)	Non Fibrous
008	CB-2	Layered	Blue Cove Base	Asbestos Not Present	NA	CaCO3 Vinyl
008a		Layered	Tan Mastic	Asbestos Not Present	NA	Glue CaCO3
008b		Layered	White Surfacing	Asbestos Not Present	NA	CaCO3
008c		Layered	Brown Mastic	Asbestos Not Present	NA	Glue
009	CB-3	Layered	Blue Cove Base	Asbestos Not Present	NA	CaCO3 Vinyl
009a		Layered	Tan Mastic	Asbestos Not Present	NA	Glue CaCO3
009b		Layered	White Surfacing	Asbestos Not Present	NA	CaCO3

Unless otherwise noted, upon receipt the condition of the sample was acceptable for analysis.

Quantem is a NVLAP accredited Testing PLM laboratory (Lab Code: 101959-0). This report relates only to the specific items tested. NVLAP accreditation applies only to analysis performed utilizing EPA—40 CFR Appendix E to Subpart E of Part 763 and EPA/600/R-93/116 methods.

This report may not be used to claim product endorsement by NVLAP or any agency of the US Government.

This report may not be reproduced except in full, without the written approval of the laboratory.





2033 HERITAGE PARK DR, OKLAHOMA CITY, OK 73120 | 1.800.822.1650

### Polarized Light Microscopy Asbestos Analysis Report

QuanTEM Lab No. 367643 Account Number: B370 Date Received: 03/28/2024 Received By: Baylie Longstreth Date Analyzed: 04/03/2024 Analyzed By: Cassie Sanborn Methodology: EPA/600/R-93/116	Client: City of Lubbock-Facility Maint. Rodney Unrein 1314 Avenue K 4th Fl Lubbock, TX 79457  Project: LIA Police Offices / Breakroom Project Location: 5401 MLK Blvd., Lubbock, TX Project Number: Police Offices / Breakroom
--	---

QuanTEM Sample ID	Client Sample ID	Composition	Color / Description	Asbestos (%)	Non-Asbestos Fiber (%)	Non Fibrous
-------------------	------------------	-------------	---------------------	--------------	------------------------	-------------

*Cassie Sanborn*

\_\_\_\_\_  
Cassie Sanborn, Laboratory Analyst

4/3/2024

\_\_\_\_\_  
Date of Report

Unless otherwise noted, upon receipt the condition of the sample was acceptable for analysis.

QuanTEM is a NVLAP accredited Testing PLM laboratory (Lab Code: 101959-0). This report relates only to the specific items tested. NVLAP accreditation applies only to analysis performed utilizing EPA—40 CFR Appendix E to Subpart E of Part 763 and EPA/600/R-93/116 methods.

This report may not be used to claim product endorsement by NVLAP or any agency of the US Government.

This report may not be reproduced except in full, without the written approval of the laboratory.



# ASBESTOS CHAIN OF CUSTODY

2033 Heritage Park Drive, Oklahoma City, OK 73120-7502  
 (800) 822-1650 • (405) 755-7272 • Fax: (405) 755-2058

## LEGAL DOCUMENT - PLEASE PRINT LEGIBLY

For Lab Use Only	
Lab No.	<u>367643</u>
<input checked="" type="checkbox"/> Accept	<input type="checkbox"/> Reject

Contact Information		Project Information		Report Results ( <input checked="" type="checkbox"/> one box)
Company: City Of Lubbock	Phone: (806) 470-4125	Project Name: LIA Police Offices / Breakroom		<input type="checkbox"/> Quantem Website
Contact: Rodney Unrein	Cell Phone: (806) 470-4125	Project Location: 5401 MLK Blvd., Lubbock, TX.		<input checked="" type="checkbox"/> Other <u>email</u>
Account #: B370	E-mail: runrein@myLubbock.us	Project ID: Police Offices / Breakroom		
SAMPLED BY: Name: Rodney Unrein	Date: 03/27/2024	P.O. Number: 3272024		

RELINQUISHED BY	DATE & TIME	VIA	RECEIVED BY	DATE & TIME
<i>Rodney Unrein</i>	3-27-24 8:00am	FedEx	<i>BG</i>	3/28/24 9:50

REQUESTED SERVICES (Please <input checked="" type="checkbox"/> the Appropriate Boxes)				
PLM	PLM	TEM	TEM	TURNAROUND TIME
<input checked="" type="checkbox"/> Bulk Analysis (EPA 600/R-93/116)	<input type="checkbox"/> Vermiculite Attic Insulation (EPA 600/R-04/004)	<input type="checkbox"/> Air- AHERA	<input type="checkbox"/> Bulk- Presence / Absence EPA600/R-93/116	<input type="checkbox"/> Rush
<input type="checkbox"/> 400 Point Count	<input type="checkbox"/> Other	<input type="checkbox"/> Air- NIOSH 7402	<input type="checkbox"/> Bulk- Quantitative [weight%]- Chatfield	<input type="checkbox"/> Same Day
<input type="checkbox"/> 1000 Point Count		<input type="checkbox"/> Air- ISO 10312	<input type="checkbox"/> Dust- Presence / Absence	<input type="checkbox"/> 24 - Hour
<input type="checkbox"/> Gravimetric Preparation	<b>PCM</b>	<input type="checkbox"/> Drinking Water- EPA 100.2	<input type="checkbox"/> Dust- Quantitative [fibers/sq.cm]- ASTM D5755	<input type="checkbox"/> 3 - Day
<input type="checkbox"/> Particle ID	<input type="checkbox"/> NIOSH 7400	<input type="checkbox"/> Waste Water- EPA 600/4-83-043	<input type="checkbox"/> Other	<input checked="" type="checkbox"/> 5 - Day

No.	Sample ID (10 Characters Max)	<input checked="" type="checkbox"/> To Be Analyzed	Color	Description	Volume / Area (as applicable)	Comments / Notes
1	DW-1	<input checked="" type="checkbox"/>	White	Drywall		+ stop
2	DW-2	<input checked="" type="checkbox"/>	↓	↓		↓
3	DW-3	<input checked="" type="checkbox"/>	↓	↓		↓
4	CP-1	<input checked="" type="checkbox"/>	Blue	Carpet		+ stop
5	CP-2	<input checked="" type="checkbox"/>	↓	↓		↓
6	CP-3	<input checked="" type="checkbox"/>	↓	↓		↓
7	CB-1	<input checked="" type="checkbox"/>	Blue	Cove Base		+ stop
8	CB-2	<input checked="" type="checkbox"/>	↓	↓		↓
9	CB-3	<input checked="" type="checkbox"/>	↓	↓		↓
10		<input type="checkbox"/>				+ stop

Police Offices



2033 HERITAGE PARK DR, OKLAHOMA CITY, OK 73120 | 1.800.822.1650

### Polarized Light Microscopy Asbestos Analysis Report

QuanTEM Lab No. <b>367649</b> Account Number: B370 Date Received: 03/28/2024 Received By: Baylie Longstreth Date Analyzed: 04/02/2024 Analyzed By: Benjamin Hill Methodology: EPA/600/R-93/116	Client: City of Lubbock-Facility Maint. Rodney Unrein 1314 Avenue K 4th Fl Lubbock, TX 79457  Project: <b>LIA East Offices / Lobby</b> Project Location: 5401 N. MLK BLVD., Lubbock, TX Project Number: <b>LIA Blue Room</b> / Operations 3rd Floor
--	--

QuanTEM Sample ID	Client Sample ID	Composition	Color / Description	Asbestos (%)	Non-Asbestos Fiber (%)	Non Fibrous
001	CP-1	Layered	Light Blue/Tan Carpet	Asbestos Not Present	Synthetic	90 Binder
001a		Layered	Yellow Mastic	Asbestos Not Present	NA	Glue
002	CP-2	Layered	Light Blue/Tan Carpet	Asbestos Not Present	Synthetic	90 Binder
002a		Layered	Yellow Mastic	Asbestos Not Present	NA	Glue
003	CP-3	Layered	Light Blue/Tan Carpet	Asbestos Not Present	Synthetic	90 Binder
003a		Layered	Yellow Mastic	Asbestos Not Present	NA	Glue
004	CP-4	Layered	Green/Tan Carpet	Asbestos Not Present	Synthetic	90 Binder

Unless otherwise noted, upon receipt the condition of the sample was acceptable for analysis.

QuanTEM is a NVLAP accredited Testing PLM laboratory (Lab Code: 101959-0). This report relates only to the specific items tested.  
 NVLAP accreditation applies only to analysis performed utilizing EPA—40 CFR Appendix E to Subpart E of Part 763 and EPA/600/R-93/116 methods.  
 This report may not be used to claim product endorsement by NVLAP or any agency of the US Government.  
 This report may not be reproduced except in full, without the written approval of the laboratory.



2033 HERITAGE PARK DR, OKLAHOMA CITY, OK 73120 | 1.800.822.1650

### Polarized Light Microscopy Asbestos Analysis Report

QuantEM Lab No. 367649	Client: City of Lubbock-Facility Maint.
Account Number: B370	Rodney Unrein
Date Received: 03/28/2024	1314 Avenue K 4th Fl
Received By: Baylie Longstreth	Lubbock, TX 79457
Date Analyzed: 04/02/2024	Project: LIA East Offices / Lobby
Analyzed By: Benjamin Hill	Project Location: 5401 N. MLK BLVD., Lubbock, TX
Methodology: EPA/600/R-93/116	Project Number: LIA Blue Room / Operations 3rd Floor

QuanTEM Sample ID	Client Sample ID	Composition	Color / Description	Asbestos (%)	Non-Asbestos Fiber (%)	Non Fibrous
004a		Layered	Yellow Mastic	Asbestos Not Present	NA	Glue CaCO3
004b		Layered	Black Padding	Asbestos Not Present	NA	CaCO3 Binder
005	CP-5	Layered	Green/Tan Carpet	Asbestos Not Present	Synthetic 90	Binder
005a		Layered	Yellow Mastic	Asbestos Not Present	NA	Glue CaCO3
005b		Layered	Black Padding	Asbestos Not Present	NA	CaCO3 Binder
006	CP-6	Layered	Green/Tan Carpet	Asbestos Not Present	Synthetic 90	Binder

Unless otherwise noted, upon receipt the condition of the sample was acceptable for analysis.

QuantEM is a NVLAP accredited Testing PLM laboratory (Lab Code: 101959-0). This report relates only to the specific items tested. NVLAP accreditation applies only to analysis performed utilizing EPA—40 CFR Appendix E to Subpart E of Part 763 and EPA/600/R-93/116 methods. This report may not be used to claim product endorsement by NVLAP or any agency of the US Government. This report may not be reproduced except in full, without the written approval of the laboratory.



2033 HERITAGE PARK DR, OKLAHOMA CITY, OK 73120 | 1.800.822.1650

### Polarized Light Microscopy Asbestos Analysis Report

QuanTEM Lab No. 367649 Account Number: B370 Date Received: 03/28/2024 Received By: Baylie Longstreth Date Analyzed: 04/02/2024 Analyzed By: Benjamin Hill Methodology: EPA/600/R-93/116	Client: City of Lubbock-Facility Maint. Rodney Unrein 1314 Avenue K 4th Fl Lubbock, TX 79457  Project: LIA East Offices / Lobby Project Location: 5401 N. MLK BLVD., Lubbock, TX Project Number: LIA Blue Room / Operations 3rd Floor
---	--

QuanTEM Sample ID	Client Sample ID	Composition	Color / Description	Asbestos (%)	Non-Asbestos Fiber (%)	Non Fibrous
006a		Layered	Yellow Mastic	Asbestos Not Present	NA	Glue CaCO3
006b		Layered	Black Padding	Asbestos Not Present	NA	CaCO3 Binder
007	CP-7	Layered	Blue/Dark Blue Carpet	Asbestos Not Present	Glass Fiber Synthetic	10 60 Binder
007a		Layered	Tan Mastic	Asbestos Not Present	NA	Glue
008	CP-8	Layered	Blue/Dark Blue Carpet	Asbestos Not Present	Glass Fiber Synthetic	10 60 Binder
008a		Layered	Tan Mastic	Asbestos Not Present	NA	Glue
009	CP-9	Layered	Blue/Dark Blue Carpet	Asbestos Not Present	Glass Fiber Synthetic	10 60 Binder

Unless otherwise noted, upon receipt the condition of the sample was acceptable for analysis.

QuanTEM is a NVLAP accredited Testing PLM laboratory (Lab Code: 101959-0). This report relates only to the specific items tested.  
 NVLAP accreditation applies only to analysis performed utilizing EPA—40 CFR Appendix E to Subpart E of Part 763 and EPA/600/R-93/116 methods.  
 This report may not be used to claim product endorsement by NVLAP or any agency of the US Government.  
 This report may not be reproduced except in full, without the written approval of the laboratory.



2033 HERITAGE PARK DR, OKLAHOMA CITY, OK 73120 | 1.800.822.1650

### Polarized Light Microscopy Asbestos Analysis Report

QuanTEM Lab No. 367649 Account Number: B370 Date Received: 03/28/2024 Received By: Baylie Longstreth Date Analyzed: 04/02/2024 Analyzed By: Benjamin Hill Methodology: EPA/600/R-93/116	Client: City of Lubbock-Facility Maint. Rodney Unrein 1314 Avenue K 4th Fl Lubbock, TX 79457  Project: LIA East Offices / Lobby Project Location: 5401 N. MLK BLVD., Lubbock, TX Project Number: LIA Blue Room / Operations 3rd Floor
---	--

QuanTEM Sample ID	Client Sample ID	Composition	Color / Description	Asbestos (%)	Non-Asbestos Fiber (%)	Non Fibrous
009a		Layered	Tan Mastic	Asbestos Not Present	NA	Glue
010	CP-10	Homogeneous	Blue/Tan Carpet	Asbestos Not Present	Glass Fiber 10 Synthetic 60	Binder
011	CP-11	Homogeneous	Blue/Tan Carpet	Asbestos Not Present	Glass Fiber 10 Synthetic 60	Binder
012	CP-12	Homogeneous	Blue/Tan Carpet	Asbestos Not Present	Glass Fiber 10 Synthetic 60	Binder
013	CT-1	Homogeneous	White Ceiling Tile	Asbestos Not Present	Cellulose 5 Glass Fiber 85	Foil Paint
014	CT-2	Homogeneous	Gray Ceiling Tile	Asbestos Not Present	Cellulose 5 Glass Fiber 85	Foil Paint

Unless otherwise noted, upon receipt the condition of the sample was acceptable for analysis.

QuanTEM is a NVLAP accredited Testing PLM laboratory (Lab Code: 101959-0). This report relates only to the specific items tested.  
 NVLAP accreditation applies only to analysis performed utilizing EPA—40 CFR Appendix E to Subpart E of Part 763 and EPA/600/R-93/116 methods.  
 This report may not be used to claim product endorsement by NVLAP or any agency of the US Government.  
 This report may not be reproduced except in full, without the written approval of the laboratory.



2033 HERITAGE PARK DR, OKLAHOMA CITY, OK 73120 | 1.800.822.1650

### Polarized Light Microscopy Asbestos Analysis Report

QuanTEM Lab No. 367649 Account Number: B370 Date Received: 03/28/2024 Received By: Baylie Longstreth Date Analyzed: 04/02/2024 Analyzed By: Benjamin Hill Methodology: EPA/600/R-93/116	Client: City of Lubbock-Facility Maint. Rodney Unrein 1314 Avenue K 4th Fl Lubbock, TX 79457  Project: LIA East Offices / Lobby Project Location: 5401 N. MLK BLVD., Lubbock, TX Project Number: LIA Blue Room / Operations 3rd Floor
---	--

QuanTEM Sample ID	Client Sample ID	Composition	Color / Description	Asbestos (%)	Non-Asbestos Fiber (%)	Non Fibrous
015	CT-3	Homogeneous	Gray Ceiling Tile	Asbestos Not Present	Cellulose Glass Fiber	5 85 Foil Paint
016	DW-1	Layered	White/Green Wall Paper	Asbestos Not Present	Synthetic	35 Vinyl Paint
016a		Layered	White Drywall	Asbestos Not Present	Cellulose Glass Fiber	10 2 Gypsum
017	DW-2	Layered	White/Green Wall Paper	Asbestos Not Present	Synthetic	35 Vinyl Paint
017a		Layered	White Drywall	Asbestos Not Present	Cellulose Glass Fiber	10 2 Gypsum
018	DW-3	Layered	White/Green Wall Paper	Asbestos Not Present	Synthetic	35 Vinyl Paint
018a		Layered	White Drywall	Asbestos Not Present	Cellulose Glass Fiber	10 2 Gypsum

Unless otherwise noted, upon receipt the condition of the sample was acceptable for analysis.

QuanTEM is a NVLAP accredited Testing PLM laboratory (Lab Code: 101959-0). This report relates only to the specific items tested.  
 NVLAP accreditation applies only to analysis performed utilizing EPA—40 CFR Appendix E to Subpart E of Part 763 and EPA/600/R-93/116 methods.  
 This report may not be used to claim product endorsement by NVLAP or any agency of the US Government.  
 This report may not be reproduced except in full, without the written approval of the laboratory.



2033 HERITAGE PARK DR, OKLAHOMA CITY, OK 73120 | 1.800.822.1650

### Polarized Light Microscopy Asbestos Analysis Report

QuantEM Lab No. 367649	Client: City of Lubbock-Facility Maint.
Account Number: B370	Rodney Unrein
Date Received: 03/28/2024	1314 Avenue K 4th Fl
Received By: Baylie Longstreth	Lubbock, TX 79457
Date Analyzed: 04/02/2024	Project: LIA East Offices / Lobby
Analyzed By: Benjamin Hill	Project Location: 5401 N. MLK BLVD., Lubbock, TX
Methodology: EPA/600/R-93/116	Project Number: LIA Blue Room / Operations 3rd Floor

QuanTEM Sample ID	Client Sample ID	Composition	Color / Description	Asbestos (%)	Non-Asbestos Fiber (%)	Non Fibrous
019	DW-4	Homogeneous	White/Yellow Drywall	Asbestos Not Present	Cellulose 10 Glass Fiber 2	Gypsum Paint
020	DW-5	Homogeneous	White/Yellow Drywall	Asbestos Not Present	Cellulose 10 Glass Fiber 2	Gypsum Paint
021	DW-6	Homogeneous	White/Yellow Drywall	Asbestos Not Present	Cellulose 10 Glass Fiber 2	Gypsum Paint
022	DW-7	Layered	White Joint Compound	Asbestos Not Present	NA	CaCO3 Paint
022a		Layered	White Drywall	Asbestos Not Present	Cellulose 10 Glass Fiber 2	Gypsum
023	DW-8	Layered	White Joint Compound	Asbestos Not Present	NA	CaCO3 Paint

Unless otherwise noted, upon receipt the condition of the sample was acceptable for analysis.

QuantEM is a NVLAP accredited Testing PLM laboratory (Lab Code: 101959-0). This report relates only to the specific items tested. NVLAP accreditation applies only to analysis performed utilizing EPA—40 CFR Appendix E to Subpart E of Part 763 and EPA/600/R-93/116 methods. This report may not be used to claim product endorsement by NVLAP or any agency of the US Government. This report may not be reproduced except in full, without the written approval of the laboratory.





2033 HERITAGE PARK DR, OKLAHOMA CITY, OK 73120 | 1.800.822.1650

### Polarized Light Microscopy Asbestos Analysis Report

Quantem Lab No. 367649	Client: City of Lubbock-Facility Maint.
Account Number: B370	Rodney Unrein
Date Received: 03/28/2024	1314 Avenue K 4th Fl
Received By: Baylie Longstreth	Lubbock, TX 79457
Date Analyzed: 04/02/2024	Project: LIA East Offices / Lobby
Analyzed By: Benjamin Hill	Project Location: 5401 N. MLK BLVD., Lubbock, TX
Methodology: EPA/600/R-93/116	Project Number: LIA Blue Room / Operations 3rd Floor

QuanTEM Sample ID	Client Sample ID	Composition	Color / Description	Asbestos (%)	Non-Asbestos Fiber (%)	Non Fibrous
023a		Layered	White Drywall	Asbestos Not Present	Cellulose 10 Glass Fiber 2	Gypsum
024	DW-9	Layered	White Joint Compound	Asbestos Not Present	NA	CaCO3 Paint
024a		Layered	White Drywall	Asbestos Not Present	Cellulose 10 Glass Fiber 2	Gypsum
025	CB-1	Layered	Brown Cove Base	Asbestos Not Present	NA	CaCO3 Vinyl
025a		Layered	Cream Mastic	Asbestos Not Present	NA	Glue
025b		Layered	Brown Mastic	Asbestos Not Present	NA	Glue
026	CB-2	Layered	Brown Cove Base	Asbestos Not Present	NA	CaCO3 Vinyl

Unless otherwise noted, upon receipt the condition of the sample was acceptable for analysis.

Quantem is a NVLAP accredited Testing PLM laboratory (Lab Code: 101959-0). This report relates only to the specific items tested. NVLAP accreditation applies only to analysis performed utilizing EPA—40 CFR Appendix E to Subpart E of Part 763 and EPA/600/R-93/116 methods. This report may not be used to claim product endorsement by NVLAP or any agency of the US Government. This report may not be reproduced except in full, without the written approval of the laboratory.



2033 HERITAGE PARK DR, OKLAHOMA CITY, OK 73120 | 1.800.822.1650

### Polarized Light Microscopy Asbestos Analysis Report

QuantEM Lab No. 367649	Client: City of Lubbock-Facility Maint.
Account Number: B370	Rodney Unrein
Date Received: 03/28/2024	1314 Avenue K 4th Fl
Received By: Baylie Longstreth	Lubbock, TX 79457
Date Analyzed: 04/02/2024	Project: LIA East Offices / Lobby
Analyzed By: Benjamin Hill	Project Location: 5401 N. MLK BLVD., Lubbock, TX
Methodology: EPA/600/R-93/116	Project Number: LIA Blue Room / Operations 3rd Floor

QuanTEM Sample ID	Client Sample ID	Composition	Color / Description	Asbestos (%)	Non-Asbestos Fiber (%)	Non Fibrous
026a		Layered	Cream Mastic	Asbestos Not Present	NA	Glue
027	CB-3	Layered	Brown Cove Base	Asbestos Not Present	NA	CaCO3 Vinyl
027a		Layered	Cream Mastic	Asbestos Not Present	NA	Glue
028	CB-4	Layered	Green Cove Base	Asbestos Not Present	NA	CaCO3 Vinyl
028a		Layered	Yellow Mastic	Asbestos Not Present	NA	Glue
028b		Layered	White Surfacing	Asbestos Not Present	NA	CaCO3 Paint

Unless otherwise noted, upon receipt the condition of the sample was acceptable for analysis.

QuantEM is a NVLAP accredited Testing PLM laboratory (Lab Code: 101959-0). This report relates only to the specific items tested. NVLAP accreditation applies only to analysis performed utilizing EPA—40 CFR Appendix E to Subpart E of Part 763 and EPA/600/R-93/116 methods. This report may not be used to claim product endorsement by NVLAP or any agency of the US Government. This report may not be reproduced except in full, without the written approval of the laboratory.



2033 HERITAGE PARK DR, OKLAHOMA CITY, OK 73120 | 1.800.822.1650

### Polarized Light Microscopy Asbestos Analysis Report

QuanTEM Lab No. 367649 Account Number: B370 Date Received: 03/28/2024 Received By: Baylie Longstreth Date Analyzed: 04/02/2024 Analyzed By: Benjamin Hill Methodology: EPA/600/R-93/116	Client: City of Lubbock-Facility Maint. Rodney Unrein 1314 Avenue K 4th Fl Lubbock, TX 79457  Project: LIA East Offices / Lobby Project Location: 5401 N. MLK BLVD., Lubbock, TX Project Number: LIA Blue Room / Operations 3rd Floor
---	--

QuanTEM Sample ID	Client Sample ID	Composition	Color / Description	Asbestos (%)	Non-Asbestos Fiber (%)	Non Fibrous
029	CB-5	Layered	Green Cove Base	Asbestos Not Present	NA	CaCO3 Vinyl
029a		Layered	Yellow Mastic	Asbestos Not Present	NA	Glue
029b		Layered	White Surfacing	Asbestos Not Present	NA	CaCO3 Paint
030	CB-6	Layered	Green Cove Base	Asbestos Not Present	NA	CaCO3 Vinyl
030a		Layered	Yellow Mastic	Asbestos Not Present	NA	Glue
030b		Layered	White Surfacing	Asbestos Not Present	NA	CaCO3 Paint

*Benjamin Hill*

Benjamin Hill, Assistant Laboratory Manager

4/2/2024

Date of Report

Unless otherwise noted, upon receipt the condition of the sample was acceptable for analysis.

QuanTEM is a NVLAP accredited Testing PLM laboratory (Lab Code: 101959-0). This report relates only to the specific items tested. NVLAP accreditation applies only to analysis performed utilizing EPA—40 CFR Appendix E to Subpart E of Part 763 and EPA/600/R-93/116 methods.

This report may not be used to claim product endorsement by NVLAP or any agency of the US Government.

This report may not be reproduced except in full, without the written approval of the laboratory.



# ASBESTOS CHAIN OF CUSTODY

2033 Heritage Park Drive, Oklahoma City, OK 73120-7502  
 (800) 822-1650 • (405) 755-7272 • Fax: (405) 755-2058

## LEGAL DOCUMENT - PLEASE PRINT LEGIBLY

For Lab Use Only	
Lab No.	<u>367649</u>
<input checked="" type="checkbox"/> Accept	<input type="checkbox"/> Reject

Contact Information		Project Information		Report Results ( <input checked="" type="checkbox"/> one box)
Company: City Of Lubbock	Phone: (806) 470-4125	Project Name: LIA East Offices / Lobby		<input type="checkbox"/> QuantEM Website
Contact: Rodney Unrein	Cell Phone: (806) 470-4125	Project Location: 5401 N. MLK BLVD., Lubbock, TX.		<input checked="" type="checkbox"/> Other <u>email</u>
Account #: B370	E-mail: runrein@myLubbock.us	Project ID: LIA Blue Room / Operations 3rd Floor		
SAMPLED BY: Name: Rodney Unrein	Date: 03/25/2023	P.O. Number: 3252024		

RELINQUISHED BY	DATE & TIME	VIA	RECEIVED BY	DATE & TIME
<i>Rodney Unrein</i>	<i>3-25-24 4:01pm</i>	<i>FEDEX</i>	<i>[Signature]</i>	<i>3/28/24 9:50</i>

REQUESTED SERVICES (Please <input checked="" type="checkbox"/> the Appropriate Boxes)				
PLM	PLM	TEM	TEM	TURNAROUND TIME
<input checked="" type="checkbox"/> Bulk Analysis (EPA 600/R-93/116)	<input type="checkbox"/> Vermiculite Attic Insulation (EPA 600/R-04/004)	<input type="checkbox"/> Air- AHERA	<input type="checkbox"/> Bulk- Presence / Absence EPA600/R-93/116	<input type="checkbox"/> Rush
<input type="checkbox"/> 400 Point Count	<input type="checkbox"/> Other	<input type="checkbox"/> Air- NIOSH 7402	<input type="checkbox"/> Bulk- Quantitative [weight%]- Chatfield	<input type="checkbox"/> Same Day
<input type="checkbox"/> 1000 Point Count		<input type="checkbox"/> Air- ISO 10312	<input type="checkbox"/> Dust- Presence / Absence	<input type="checkbox"/> 24 - Hour
<input type="checkbox"/> Gravimetric Preparation	PCM	<input type="checkbox"/> Drinking Water- EPA 100.2	<input type="checkbox"/> Dust- Quantitative [fibers/sq.cm]- ASTM D5755	<input type="checkbox"/> 3 - Day
<input type="checkbox"/> Particle ID	<input type="checkbox"/> NIOSH 7400	<input type="checkbox"/> Waste Water- EPA 600/4-83-043	<input type="checkbox"/> Other	<input checked="" type="checkbox"/> 5 - Day

No.	Sample ID (10 Characters Max)	<input checked="" type="checkbox"/> To Be Analyzed	Color	Description	Volume / Area (as applicable)	Comments / Notes
1	CP-1	<input checked="" type="checkbox"/>	LT Blue / Tan	Carpet		+ stop
2	CP-2	<input checked="" type="checkbox"/>	↓	↓		↓
3	CP-3	<input checked="" type="checkbox"/>	↓	↓		↓
4	CP-4	<input checked="" type="checkbox"/>	Green / Tan	Carpet		+ stop
5	CP-5	<input checked="" type="checkbox"/>	↓	↓		↓
6	CP-6	<input checked="" type="checkbox"/>	↓	↓		↓
7	CP-7	<input checked="" type="checkbox"/>	Blue / Dk Blue	Carpet		+ stop
8	CP-8	<input checked="" type="checkbox"/>	↓	↓		↓
9	CP-9	<input checked="" type="checkbox"/>	↓	↓		↓
10	CP-10	<input checked="" type="checkbox"/>	Blue / Tan	Carpet		+ stop

**SATURDAY SAMPLE DELIVERY - CALL TO SCHEDULE** • Use this address for Saturday Delivery only: 4220 N. Santa Fe Ave., Oklahoma City, OK 73105-8517 • Mark Package "Hold for Saturday Pickup"

Blue (B) Room



# ASBESTOS CHAIN OF CUSTODY

2033 Heritage Park Drive, Oklahoma City, OK 73120-7502  
 (800) 822-1650 • (405) 755-7272 • Fax: (405) 755-2058

For Lab Use Only	
Lab No.	367649
<input checked="" type="checkbox"/> Accept	<input type="checkbox"/> Reject

**LEGAL DOCUMENT - PLEASE PRINT LEGIBLY**

Project Information						
Company: City Of Lubbock			Project Name: LIA East Offices / Lobby		Project Location: 5401 N. MLK BLVD., Lubbock, TX.	
No.	Sample ID (10 Characters Max)	<input checked="" type="checkbox"/> To Be Analyzed	Color	Description	Volume / Area (as applicable)	Comments / Notes
11	CP-11	<input checked="" type="checkbox"/>	↓	↓		↓
12	CP-12	<input checked="" type="checkbox"/>	↓	↓		↓
13	CT-1	<input checked="" type="checkbox"/>	Grey	Ceiling Tile		+ stop
14	CT-2	<input checked="" type="checkbox"/>	↓	↓		↓
15	CT-3	<input checked="" type="checkbox"/>	↓	↓		↓
16	DW-1	<input checked="" type="checkbox"/>	White	Drywall		+ stop
17	DW-2	<input checked="" type="checkbox"/>	↓	↓		↓
18	DW-3	<input checked="" type="checkbox"/>	↓	↓		↓
19	DW-4	<input checked="" type="checkbox"/>	Yellow	Drywall		+ stop
20	DW-5	<input checked="" type="checkbox"/>	↓	↓		↓
21	DW-6	<input checked="" type="checkbox"/>	↓	↓		↓
22	DW-7	<input checked="" type="checkbox"/>	Blue	Drywall		+ stop
23	DW-8	<input checked="" type="checkbox"/>	↓	↓		↓
24	DW-9	<input checked="" type="checkbox"/>	↓	↓		↓
25	CB-1	<input checked="" type="checkbox"/>				+ stop
26	CB-2	<input checked="" type="checkbox"/>				↓
27	CB-3	<input checked="" type="checkbox"/>				↓
28	CB-4	<input checked="" type="checkbox"/>				+ stop
29	CB-5	<input checked="" type="checkbox"/>				↓
30	CB-6	<input checked="" type="checkbox"/>				↓

\* Samples added per Rodney Unrein - 3/29/24 11:05

**SATURDAY SAMPLE DELIVERY - CALL TO SCHEDULE** • Use this address for Saturday Delivery only: 4220 N. Santa Fe Ave., Oklahoma City, OK 73105-8517 • Mark Package "Hold for Saturday Pickup"

Blue (B) Room

