

## ADDENDUM NO: 001

TO:	Prospective Bidders
FROM:	Parkhill
PROJECT NAME:	UMC OR – 8 RENOVATION
PROJECT NO.:	03.9049.22
DATE:	April 18, 2024

Attention of all Prospective Proposers/Plan Holders is directed to the following modifications to the referenced Drawings and Project Manual. This Addendum becomes a part of the Contract Documents and modifies the original Contract Documents dated April 2, 2024 as noted below:

This Addendum consists of one (1) page and drawing A-131.

### I. CHANGES TO PROJECT MANUAL:

1. SPEC SECTION 08 31 13 – ACCESS DOORS AND FRAMES
  - a. Paragraph 2.1.- ADD the following product information as indicated below:
    - “B. General Purpose Access Door:
      1. Manufacturers: Subject to compliance with requirements, available manufacturers offering products that may be incorporated into the Work include, but are not limited to, the following:
        - a. Best Access Doors
      2. Description: Face of concealed-hinge door flush with frame, with concealed flange for metal stud and gypsum board installation.
      3. Optional Features: Neoprene gasketing.
      4. Locations: Ceiling.
      5. Door Size: 24-inch x 24-inch.
      6. Door Type: Concealed-hinge, radius corner; Model BA-AHD-60.
      7. Door and Frame Material and Finish: 16 gauge cold rolled steel with high0 quality white powder coat primer.
      8. Hinge Type: Continuous piano type hinge.
      9. Latch and Lock: Cam lock, screwdriver operated.”

### II. CHANGES TO DRAWINGS:

1. SHEET A-131 Reflected Ceiling Plan
  - a. UPDATE: verbiage to keynote 008
  - b. UPDATE: Boom Support Notes on drawing C1

END OF ADDENDUM 001

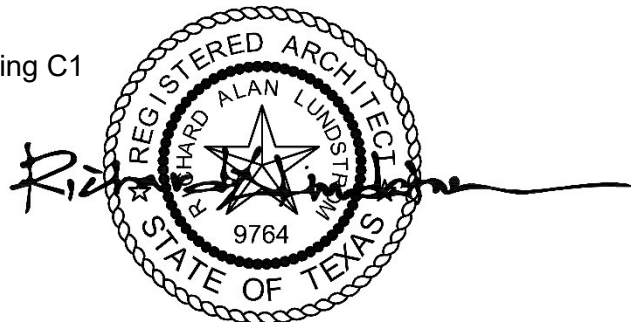

4/18/2024

**BOOM SUPPORT NOTES**

- A. GC COORDINATE LOCATIONS, HEIGHTS, ETC. WITH EQUIPMENT BOOM DRAWINGS. SUBMIT RFI WITH ANY DISCREPANCY BETWEEN, EXISTING DRAWINGS, EQUIPMENT DRAWINGS, AND ACTUAL FIELD CONDITIONS.
- B. SUPPORTS FOR BOOM ANCHOR PLATES SHALL BE ENGINEERED, SEALED, AND SUPPLIED BY UNISTRUT. COORDINATE UNISTRUT REQUIREMENTS WITH EQUIPMENT BOOM DRAWINGS. UNISTRUT DRAWINGS SHALL BE SUBMITTED FOR APPROVAL.
- C. EXISTING STRUCTURAL DRAWINGS CAN BE PROVIDED ONLY FOR REFERENCE. FIELD VERIFY ALL EXISTING CONDITIONS.

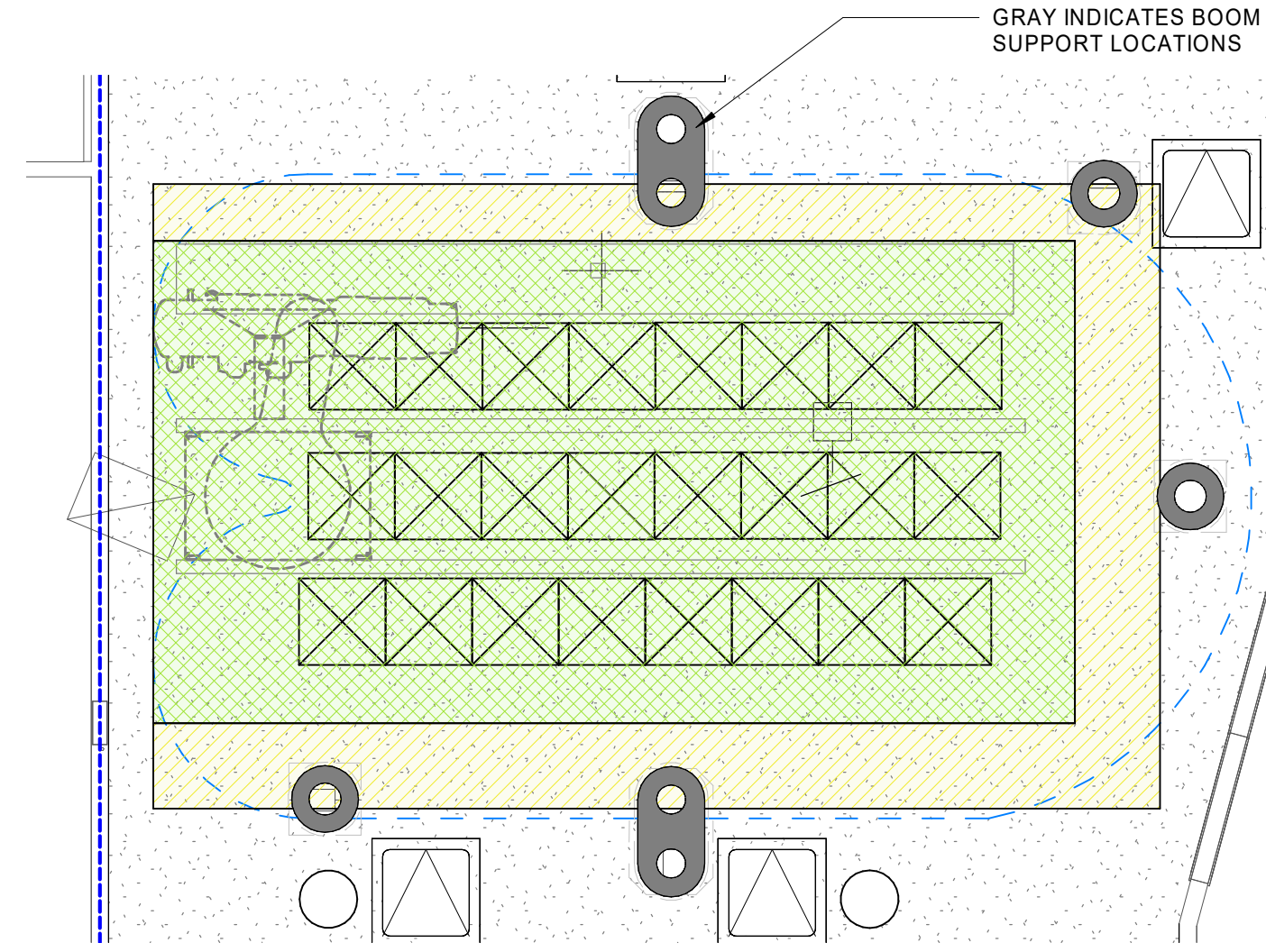

**C1 REFLECTED CEILING PLAN - BOOM SUPPORTS**  
1/4" = 1'-0"

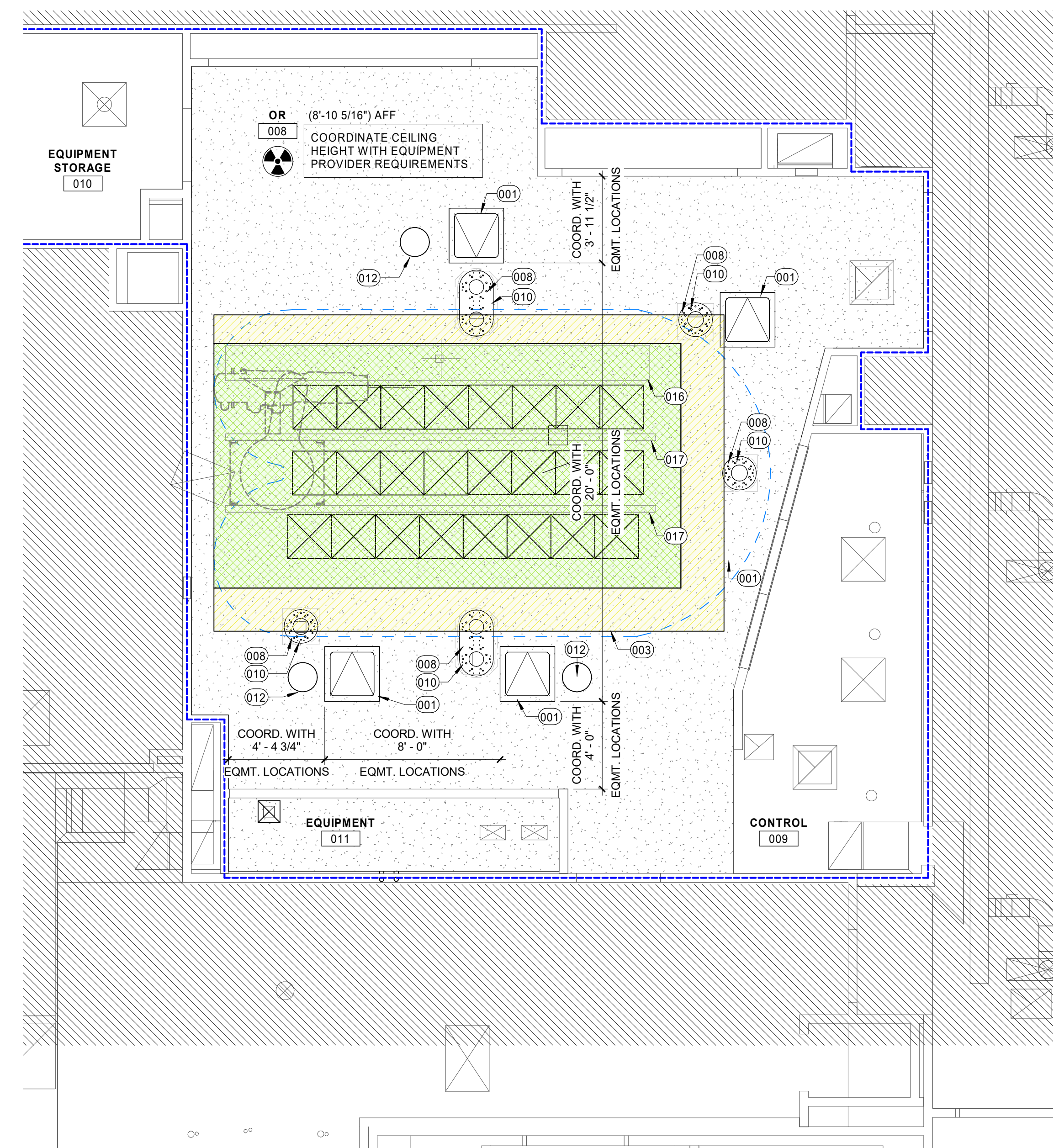

**A3 REFLECTED CEILING PLAN - STATIC**  
1/4" = 1'-0"

**GENERAL NOTES**

- A. DIMENSIONS ARE TO FACE OF STUD, CMU, OR CENTERLINE OF STRUCTURE UNO.
- B. COORDINATE WITH MEP DRAWINGS FOR LOCATIONS OF FIXTURES. LOCATE AS SHOWN ON ARCHITECTURAL PLANS AND DETAILS. NOTIFY ARCHITECT OF CONFLICTS PRIOR TO CONSTRUCTION.
- C. FINAL SPRINKLER HEAD LOCATIONS SHALL BE SET BY FIRE PROTECTION ENGINEER AND APPROVED BY ARCHITECT.
- D. CENTER DEVICES, SPRINKLER HEADS, ETC. IN CEILING TILES UNO.
- E. CEILING HEIGHT SHALL BE 9' - 0" ABOVE FINISHED FLOOR.
- F. REFER TO INTERIOR ELEVATIONS AND ROOM FINISH SCHEDULE FOR ADDITIONAL INFORMATION CONCERNING HEIGHTS, CEILING MATERIALS AND FURRED CEILINGS.
- G. AT LOCATIONS OF PERFORATED RETURN AIR GRILLES, WIRING, CABLING, ETC. TO BE HELD CLEAR OF OPEN LINE OF SIGHT THROUGH GRILLE. IN CASES WHERE THIS IS UNAVOIDABLE, ITEMS VISIBLE ABOVE GRILLE ARE TO BE PAINTED FLAT BLACK.
- H. WHERE DEMOLITION CAUSES DAMAGE OR REMOVAL OF SOUND BATT INSULATION, REPLACE TO MATCH EXISTING CONDITION.

**KEY NOTES**

- AS INDICATED BY: (#) →
- 001 CEILING ACCESS PANEL; COORD LOCATION WITH EQUIPMENT DRAWINGS TO BE LOCATED NEAR MED GAS PLUMBING; INSTALL FLUSH WITH CEILING FINISH AND PAINT TO MATCH CEILING FINISH; REF INTERIOR
  - 003 COORDINATE CEILING PROTRUSION RESTRICTIONS WITH EQUIPMENT PROVIDER
  - 008 BOOM ANCHOR PLATE; REF C1/A-131 FOR ATTACHMENT TO STRUCTURE ABOVE; COORDINATE FINAL LOCATION WITH EQUIPMENT PROVIDER SITE SPECIFIC DRAWINGS
  - 010 CEILING COVER BY EQUIPMENT PROVIDER
  - 012 SPEAKER; COORDINATE FINAL LOCATION WITH EQUIPMENT INTEGRATION DRAWINGS
  - 016 CABLE DUCT; REFER TO EQUIPMENT PROVIDER DRAWINGS
  - 017 SUPPORT RAIL; REFER TO EQUIPMENT PROVIDER DRAWINGS

**LEGEND**

- GYPSUM BOARD CEILING
- DENOTES SOUND INSULATION (REFER TO GENERAL NOTES)
- RADIATION PROTECTED ROOM
- NO FLY ZONES**  
COORDINATE WITH EQUIPMENT PROVIDER DRAWINGS FOR SPECIFIC REQUIREMENTS FOR EACH ZONE

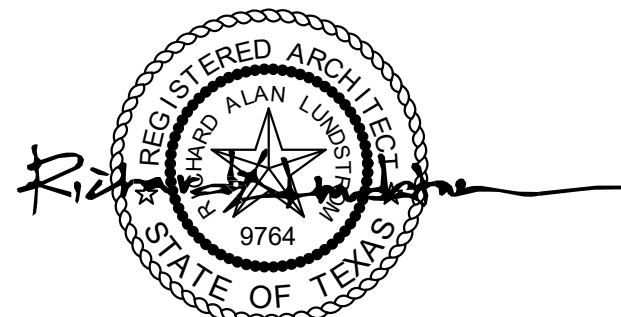

04/17/2024

Parkhill.com

**Operating Room #08**  
Equipment Change-Out



**CLIENT**  
University Medical Center (UMC)

602 Indiana Avenue  
Lubbock, Texas 79415

**PROJECT NO.**  
9049.22

#	DATE	DESCRIPTION
1	04/17/2024	ADDM - 001
-	04/02/2024	Construction Documents

**Reflected Ceiling Plan**

**A-131**

R\_1/22 4/17/2024 3:56:52 PM

